



MGM Industries

*SIMULATION PERFORMANCE &
SOLAR HEAT GAIN REPORT*

*Series "5010"
Single Hung*

NCTL-110-10901-01

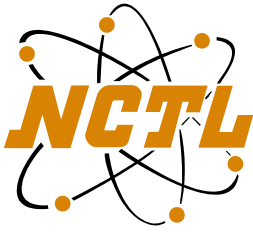

NATIONAL CERTIFIED TESTING LABORATORIES

FIVE LEIGH DRIVE • YORK, PENNSYLVANIA 17406 • TELEPHONE (717) 846-1200
FAX (717) 767-4100
www.nctlinc.com

Simulation Performance, Solar Heat Gain Coefficient, Visible Transmittance and Condensation Resistance Calculation Report

REPORT NO: NCTL-110-10901-01
SIMULATION DATE: 09/13/07
REPORT DATE: 09/13/07

Client: MGM Industries
287 Freehill Road
Hendersonville, TN 37075

Product Line: MGM Industries' Series "5010" Single Hung

Specification: NFRC 100-2004: "Procedure for Determining Fenestration Product U-Factors".
NFRC 200-2004: "Procedure for Determining Fenestration Product Solar Heat
Gain Coefficients and Visible Transmittance at Normal Incidence".
NFRC 500-2004: "Procedure for Determining Fenestration Product
Condensation Resistance Values".
Therm 5.x / Window 5.x NFRC Simulation Manual (Approved at test date)

**Procedures
and
Compliance:** All U-factor, Solar Heat Gain Coefficients, Visible Transmittance and
Condensation Resistance values were calculated using the following
characteristics: a default value of 0.30 solar absorptance for all products
other than window glazed wall and sloped glazing which have a solar
absorptance of 0.50. The best glazing option was used as the configuration
for SHGC and VT specialty products table. NCTL is a NFRC accredited
simulation laboratory and this simulation was conducted in full compliance
with NFRC requirements. This report does not constitute an opinion or
endorsement by the laboratory. Ratings values included in this report are for
submittal to an NFRC-licensed IA and are not meant to be used directly for
labeling purposes. Only those values identified on a valid Certification
Authorization Report (CAR) by an NFRC accredited Inspection Agency (IA) are
to be used for labeling purposes. Rounding per IEEE/ASTM SI 10-1997
except section 5.4.1.3.

PRODUCT LINE DESCRIPTION

General: The product line modeled is MGM Industries' Series "5010" Single Hung.

Model Size Simulations: 1200mm x 1500mm (47.244" x 59.055")

Note: All product drawings are included in Attachment A.

Weatherseals:

Location	Weather Seal Description
Head	(1) single strip of weather-strip
Meeting Rail	(2) single strip of weather-strip
Sill	(1) single strip of weather-strip and (1) bulb seal
Top Jamb	None
Bottom Jamb	(2) single strip of weather-strip

Reinforcement: A U-Shaped piece of extruded aluminum was modeled in the keeper rail.

Finish: Vinyl

Dividers: Where applicable, dividers were not modeled because the gap between dividers and lites were greater than 3mm. For Solar Heat Gain and Visual Light Transmittance default dividers less than 1" and greater or equal to 1" and default patterns were used for simulations.

Group Leaders: The following group leaders are actual simulated individual products per NFRC 4.2.4 and the NFRC Technical Interpretations where applicable. All remaining individual products' U-factors in the corresponding groups are represented by the group leader's U-factor.

COG Group Leader: Individual products which differ from another (base) individual product in glazing tint and/or obscurity (including obscure glass, fritted glass, and wired glass) only may be assumed to have the same U-factor as the base product unless this change is associated with a change in coating properties.

COG Group Leader:

Glazing ID	Glazing Description	U _{COG}
002	SS AFG TiAC36 (e= .034 on 2) / .428" Air / SS AFG Clear	0.303*
004	SS AFG TiAC36 (e= .034 on 3) / .389" Air / SS AFG Clear	0.316*

* Group Leader

Modeling Assumptions and Comments Deemed Important:**Sealing Rules:**

All cavities that are opened to the exterior within a frame section shall be modeled according to ISO 15099, Section 6.7.1, which states that cavities greater than 2mm but equal to or less than 10 mm shall be modeled as "slightly ventilated air cavities". For physical testing purposes the product is sealed at the inside surface with tape or equivalent to prevent air infiltration. Air cavities created by this sealing technique must be simulated with the standard NFRC "Frame Cavity" material. If cavities on the frame are sealed (covered) to the surround panel with tape or equivalent, those cavities are also filled with NFRC "Frame Cavity" material within the simulation model. If the frame is not covered or sealed, those areas are left hollow or opened within the simulation model.

Continuous elements:

All elements continuous within the product line are identified from the Bill-of-Materials and detailed drawings via the referenced dimensions and cut lengths as compared to the overall size of the product.

General Notes:

The Condensation Resistance results obtained from this procedure are for controlled laboratory conditions and do not include the effects of air movement through the specimen, solar radiation, and the thermal bridging that may occur due to the specific design and construction of the fenestration system opening.

Modeling assumptions:

The product was modeled with a nominal 1" x 4" wood stud attached to the exterior flange.

Miscellaneous assumptions:

1. The screen extrusions were not modeled.
2. All radii are simulated at angles.
3. Any spacer simulated using a spacer system from the Frame Spacer Library match the required configurations for this manufacturer's spacer system.
4. The modeling was performed in accordance with the manufacturer's assembly drawing from a DXF file.

Component Area and Frame Heights:

Frame heights, calculated areas, area weighted values for U-factor, SHGC, and VT, and center -of-glazing are located in approved NFRC simulation programs for all individual products.

Specialty Products Table: The specialty products method allows the manufacturer to determine the overall product SHGC and VT for any glazing option. The center of glass SHGC and/or VT must be determined using WINDOW 5.2. The method gives overall product SHGC and VT indexed on center of glass properties.

SHGC	No Dividers	Dividers <1"	Dividers ≥1"
0.00	0.002	0.005	0.008
1.00	0.820	0.736	0.657

VT	No Dividers	Dividers <1"	Dividers ≥1"
0.00	0.000	0.000	0.000
1.00	0.818	0.731	0.649

$$SHGC = SHGC_0 + SHGC_{COG} (SHGC_1 - SHGC_0)$$

$$VT = VT_0 + VT_{COG} (VT_1 - VT_0)$$

NCTL Therm Section Filename Methodology

Filename Codes Example: CU_HD2_003.THM	
CU	Spacer (Intercept)
HD	Frame Section (Head)
2	Glass Size (2.5mm)
003	Glazing ID #3

Individual Product Descriptions and Model Size Matrix of U-Factors, SHGC, VT & CR

All U-factors are given in BTU/HR/ft²/°F

Product Description	Product Number	Pane ID (Exterior)	Pane ID (Interior)	Pane Thickness (Exterior)	Pane Thickness (Interior)	Gap	Gap Fill	Emissivity Surface 2	Emissivity Surface 3	U-factor C-O-G	SHGC C-O-G	VT C-O-G	Spacer	Grid Type	Tint	U-factor	Condensation Resistance	Solar Heat Gain Coefficient (ND)	Visual Transmittance (ND)	Solar Heat Gain Coefficient (<1")	Visual Transmittance (<1")	Reference Notes
TiAC36#2_SS_AIR	001	964	885	0.098	0.098	0.428	AIR	0.034		0.30	0.37	0.69	CU-D	N,G	LE	0.35	51	0.30	0.56	0.28	0.50	
TiAC36#3_SS_AIR		885	964	0.098	0.098	0.428	AIR		0.034	0.30	0.46	0.69	CU-D	N,G	LE	0.35	51	0.38	0.56	0.34	0.50	
TiAC36#2_DS_AIR	002	965	887	0.118	0.118	0.389	AIR	0.034		0.32	0.37	0.68	CU-D	N	LE	0.36	50	0.30	0.56	NA	NA	
TiAC36#3_DS_AIR		887	965	0.118	0.118	0.389	AIR		0.034	0.32	0.46	0.68	CU-D	N	LE	0.36	50	0.38	0.56	NA	NA	
CLR_SS_AIR	003	885	885	0.098	0.098	0.428	AIR			0.49	0.80	0.83	CU-D	N,G	CL	0.50	41	0.66	0.68	0.59	0.61	
CLR_DS_AIR	004	887	887	0.118	0.118	0.389	AIR			0.50	0.79	0.82	CU-D	N	CL	0.50	41	0.64	0.67	NA	NA	
TiAC36#2_DS_AIR	005	965	887	0.118	0.118	0.389	AIR	0.034		0.32	0.37	0.68	CU-D	G	LE	0.38	50	NA	NA	0.27	0.50	1
TiAC36#3_DS_AIR		887	965	0.118	0.118	0.389	AIR		0.034	0.32	0.46	0.68	CU-D	G	LE	0.38	50	NA	NA	0.34	0.50	1
CLR_DS_AIR	006	887	887	0.118	0.118	0.389	AIR			0.50	0.79	0.82	CU-D	G	CL	0.51	41	NA	NA	0.58	0.60	1

Reference Notes: 1. Modeled with .190" x .805" Rectangular Divider

A baseline product test in accordance with the "NFRC 102: Test Procedure for Measuring the Steady-State Thermal Transmittance of Fenestration Systems" is required in order to validate the "Model Size Matrix of U-Values" as previously indicated. Per Section 1.4.3 of NFRC 100-2004, "the baseline product is the individual product selected for validation testing". **The individual product selected as the baseline product shall be the lowest simulated individual product or an individual product having a simulated U-factor within 0.60 W/(m²*K) (0.10 BTU/HR/ft²/°F) or 20% of the listed lowest simulated U-factor.**

Note:

1. For lowest U-factor listings where multiple individual products are shown, validation testing can be conducted on any of the configurations listed.
2. Actual simulated individual products are required for product line validation testing.
3. All individual products in the product line were simulated using the approved NFRC THERM program.

-----> Res sizes

For the purposes of validation testing, production line units and sizes shall be used to represent the baseline product. Per the client, the model size is manufactured as part of their product line; therefore the previously listed model size can be used for baseline product validation testing.

-----> Deviation Sizes

For the purposes of validation testing, production line units and sizes shall be used to represent the baseline products. Representative sizes are therefore defined as the production sizes with the least deviation (D) from the model sizes, calculated per NFRC 100. The previously listed model sizes shall be used for baseline product validation testing.

Copies of this report and the detailed product drawings will be retained by NCTL for a period of four (4) years. This report may not be reproduced, except in full, without the approval of NCTL. The results only to the fenestration product simulated. The attached diskette(s) contain(s) all required NFRC data and software files.

NATIONAL CERTIFIED TESTING LABORATORIES

A digital signature of Justin M. Robinson, featuring a stylized cursive script of his name. Below the signature is a small logo for NCTL (National Certified Testing Laboratories) and the text "DIGITAL SIGNATURE".

JUSTIN M. ROBINSON

NFRC Accredited Simulator

Simulator-In-Responsible-Charge

Attachments

Report Log

Product Line: *MGM Industries' Series Series 5010 Single Hung*

Date:
09/13/07 - *Original Report issued to MGM Industries and Inspection Agency*

Door	
Code	Description
EM	Embossed
FL	Flush
LF	Full Lite
LH	1/2 - Lite
LQ	1/4 - Lite
LT	3/4 - Lite
N	Not Applicable
RP	Raised Panel

Grid	
Code	Description
G	Grids between the glass
N	No Muntins
S	Simulated Divided Lites
T	True Muntins

Sealant	
Code	Description
D	Dual Seal Spacer System
N	Not Applicable
S	Single Seal Spacer System

Gap Fill	
Code	Description
AIR	Air
AR3	Argon/Krypton/Air Mixture
ARG	Argon
KRY	Krypton
N	Not Applicable

Glass Tint	
Code	Description
AZ	Azurlite
BG	Blinds between the Glazing
BL	Blue
BZ	Bronze
CL	Clear
DV	Dynamic Glazing (Variable)
DY	Dynamic Glazing (Non-Variable)
EV	Evergreen
GC	Gold (reflective coating)
GD	Gold
GR	Green
GY	Gray
LE	Low 'e' Coating
OT	Other (use comment field)
RC	Solar or Reflective Coating
RG	Roller shades between Glazing
RS	Silver (reflective coating)
SF	Suspended Polyester Film
SR	Silver

Spacer		
Code	Type	Definition
A1-D	Aluminum	Aluminum spacer system - dual sealed.
A1-S	Aluminum	Aluminum spacer system - single sealed.
A2-D	Aluminum (thermally-broken)	Thermally improved aluminum spacer system - dual sealed.
A2-S	Aluminum (thermally-broken)	Thermally improved aluminum spacer system - single sealed.
A3-D	Aluminum-reinforced polymer	Polymer spacer material with aluminum substance - dual sealed.
A3-S	Aluminum-reinforced polymer	Polymer spacer material with aluminum substance - single sealed.
A4-D	Aluminum/Wood	Composite spacer system of two materials - dual sealed.
A4-S	Aluminum/Wood	Composite spacer system of two materials - single sealed.
A5-D	Aluminum-reinforced butyl	Butyl spacer material with aluminum substrate - dual sealed.
A5-S	Aluminum-reinforced butyl	Butyl spacer material with aluminum substrate - single sealed.
A6-D	Aluminum/Foam/Aluminum	Two aluminum spacers separated by foam-type material - dual sealed
A6-S	Aluminum/Foam/Aluminum	Two aluminum spacers separated by foam-type material - single sealed
A7-D	Aluminum U-shaped	U-shaped spacer system embedded in sealant - dual sealed.
A7-S	Aluminum U-shaped	U-shaped spacer system embedded in sealant - single sealed.

Spacer		
Code	Type	Definition
A8-D	Aluminum-Butyl Composite	Exposed corrugated aluminum spacer with butyl - dual sealed.
A8-S	Aluminum-Butyl Composite	Exposed corrugated aluminum spacer with butyl - single sealed.
CS-D	Coated Steel	Coated Steel (galvanized or tinplated) - Dual seal
CS-S	Coated Steel	Coated Steel (galvanized or tinplated) - Single seal
CU-D	Coated Steel U-Shaped	Coated Steel (galvanized or tinplated) U-shaped spacer system embedded in sealant - Dual sealed
CU-S	Coated Steel U-Shaped	Coated Steel (galvanized or tinplated) U-shaped spacer system embedded in sealant - Single sealed
ER-D	EPDM Reinforced Butyl	EPDM reinforced butyl spacer system - dual sealed.
ER-S	EPDM Reinforced Butyl	EPDM reinforced butyl spacer system - single sealed.
FG-D	Fiberglass	Fiberglass - dual sealed.
FG-S	Fiberglass	Fiberglass - single sealed.
GL-S	Glass	Welded glass edge condition at glazing perimeter.
N	Not Applicable	
OF-D	Organic Foam	Organic-based foam spacer system - dual sealed.
OF-S	Organic Foam	Organic-based foam spacer system - single sealed.
P1-D	Polycarbonate- Butyl Composite	Exposed corrugated polycarbonate spacer with butyl - dual sealed.
P1-S	Polycarbonate- Butyl Composite	Exposed corrugated polycarbonate spacer with butyl - single sealed.
PU-D	Polyurethane foam	Polyurethane foam - dual sealed.
PU-S	Polyurethane foam	Polyurethane foam - single sealed.
S2-D	Steel (thermally-broken)	Stainless steel spacer with urethane thermal break - dual sealed.
S2-S	Steel (thermally-broken)	Stainless steel spacer with urethane thermal break - single sealed.
S3-D	Steel/Foam/Steel	Two steel spacers separated by foam-type material - dual sealed.
S3-S	Steel/Foam/Steel	Two steel spacers separated by foam-type material - single sealed.
S5-D	Steel reinforced butyl	Butyl spacer material with stainless steel substrate - dual sealed.
S5-S	Steel reinforced butyl	Butyl spacer material with stainless steel substrate - single sealed.
S6-D	Steel U-channel w/ thermal cap	U-shaped steel spacer system with a thermal cap - dual sealed.
S6-S	Steel U-channel w/ thermal cap	U-shaped steel spacer system with a thermal cap - single sealed.
SS-D	Stainless Steel	Stainless Steel - Dual Seal
SS-S	Stainless Steel	Stainless Steel - Single Sealed
SU-D	Stainless Steel U-Shaped	Stainless Steel U-shaped spacer system embedded in sealant - Dual sealed
SU-S	Stainless Steel U-Shaped	Stainless Steel U-shaped spacer system embedded in sealant - Single sealed
TP-D	Thermo-plastic	Thermo-plastic - dual sealed.
TP-S	Thermo-plastic	Thermo-plastic - single sealed.
TS-D	Thermo-plastic	Thermoplastic spacer with stainless steel substrate - dual-sealed
TS-S	Thermo-plastic	Thermoplastic spacer with stainless steel substrate - single-sealed
WD	Wood	Wood spacer system
ZF-D	Silicone Foam	Silicone foam spacer system - dual sealed.
ZF-S	Silicone Foam	Silicone foam spacer system - single sealed.
ZS-D	Silicone/Steel	Combination of two separate spacers: a steel spacer and silicone spacer - dual sealed.
ZS-S	Silicone/Steel	Combination of two separate spacers: a steel spacer and silicone spacer - single sealed.

ATTACHMENT A

Product Drawings

TEST SPECIMEN COMPLIES
 WITH THESE DETAILS.
 ANY DEVIATION IS NOTED.
 TEST COMPLETE: 9/18/07
 NCTL-110-10901

Bill of Materials Listing

Print Date: Aug 16, 2007

Product: 5010

Type: SH

<---Deducts--->

Assembly Code Part # Description Qty Height Width Unit Code Vert Hor Sub Assy Add Color Fixed Length W/Nailing Fin

Assembly Code	Part #	Description	Qty	Height	Width	Unit Code	Vert	Hor	Sub Assy	Add Color	Fixed Length	W/Nailing Fin
ASSCR1	6X7/BFH	Keeper Screw	4.00			EA			IA			
ASSCR2	8AX1-3/4TRUSS	Meeting Rail Screw	4.00			EA			IA	N		
BALCOV	VR-879	Balance Cover	2.00	.3750		LI	H		IA	Y		
GLASS	1CL	Default Glass Type	1.00	1.8750	2.9375	SF			IA	N		
GLSSPC	675412	Glass Spacer	2.00		2.9375	LI	W		IA			
HEADER	V-185	Top Extrusion	2.00		2.8125	LI	W		IA	Y		
KEEPER	8422	Keeper	2.00			EA			IA			
LJAMB	V-185	Left Side Extrusion	2.00	2.8125		LI	H		IA	Y		
MISC	SWGG-7-16	Butyl	2.00		2.9375	EA	W		IA			SWGG-7/16
MISC	SWGG-7/16	Butyl	2.00	1.8750	.0000	EA	H		IA			SWGG-7/16
MLSTFH	42039	Mullion Stiffener (H)	1.00		2.8125	LI	W		IA			
MTRAIL	M-159	Meeting Rail	1.00		2.8125	LI	W		IA	Y		
MULSEB	1	Setting From Bottom	1.00	.4375		LI	H		IA			
MULSEB	1	Setting From Top	1.00	.3750		LI	H		IA			
MUNCLP	12347-000	Muntin Clips	6.00			EA			IA			
MUNTNH	120874	Muntin Bar Horizontal	1.00		3.5625	LI	W		IA			
MUNTNV	120874	Muntin Bar Vertical	1.00	5.1250		LI	H		IA			
SILL	V-162	Bottom Extrusion	1.00		2.8125	LI	W		IA	Y		

End of Subassembly IA *****

ASSCR1	8X1PH	Sash Assembly Screw	4.00			EA			IB			
ASSCR2	8X1FH	Assembly Screw #2	8.00			EA			IB			
ASSCR3	6X1/2PH	Spring Balance Screw	2.00			EA			IB	N		
GLASS	1CL	Default Glass Type	1.00	1.8750	2.9375	SF			IB	N		
GLSSPC	SWGG-7/16	Glass Spacer	2.00		2.9375	LI	W		IB			SWGG-7/16
GLSSPC	SWGG-7/16	Glass Spacer	2.00	1.8750		LI	H		IB			SWGG-7/16
HEADER	V-391	Bottom Bulb Extrusion	1.00		2.8125	LI	W		IB	Y		

TEST SPECIMEN COMPLIES
 WITH THESE DETAILS.
 ANY DEVIATION IS NOTED.
 TEST COMPLETE: 9/18/07
 NCTL-110-10901

Bill of Materials Listing

Print Date: Aug 16, 2007

Product: 5010

Type: SH

Assembly Code Part # Description Qty Height Width Unit Code Vert Hor Assy Add Color Fixed Length W/Nailing Fin

Assembly Code	Part #	Description	Qty	Height	Width	Unit Code	Vert	Hor	Assy	Add Color	Fixed Length	W/Nailing Fin
HEADER	V-162	Frame Top Extrusion	1.00		2.8125	LI	W		IB	Y		
LATCH	340/341	Latch	1.00			EA			IB			
LJAMB	V-160	Left Side Extrusion	1.00	-.3750		LI	H		IB	Y		
LOCK	VIG3288	Lock	2.00			EA			IB			
MISC	5/8X3/4X1/8	Glass Setting Block	2.00			EA			IB			
MUNCLP	12347-000	Muntin Clips	6.00			EA			IB			
MUNTNH	120874	Muntin Bar Horizontl	1.00		3.5625	LI	W		IB			N
MUNTNV	120874	Muntin Bar Vertical	1.00	5.1250		LI	H		IB			N
RJAMB	V-160	Right Side Extrusion	1.00	-.3750		LI	H		IB	Y		
SCAULK	100	SILICONE	.20			EA			IB			
SILL	V-161	Bottom Extrusion	1.00		2.8125	LI	W		IB	Y		
TLTKEY	PB250	Tilt Pivot Bar	2.00			EA			IB			
WTSTPH	W432519W	Weather Strip(H)	2.00		2.8125	LI	W		IB			
WTSTPV	W432519W	Weather Strip(V)	2.00	-.7500		LI	H		IB			

End of Subassembly IB *****

ASSCR2	8X1PH	Assembly Screw #2	6.00			EA			MF			
ASSCR3	10X1/2TRUSS	Balance Screw	2.00			EA			MF			N
BALSHO	HILL	Balance Shoes	2.00			EA			MF			
HEADER	V-379	Frame Top Extrusion	1.00		-.2500	LI	W		MF	Y		V-379
JAMEXS	WOOD2	Jamb Extension	2.00	-.2500		LI	H		MF			WOOD2
JAMEXT	WOOD2	Jamb Extension	2.00		1.2500	LI	W		MF			WOOD2
LJAMB	V-379	Left Side Extrusion	1.00	.0000		LI	H		MF	Y		V-379
MISC	ERCSCW006D402	Sill Pads	2.00			EA			MF			N
RJAMB	V-379	Right Side Extrusion	1.00	.0000		LI	H		MF	Y		V-379
SHSTRP	WRAP	Clear Plastic Wrap	1.00		.0000	EA			MF			
SILL	M-130	Bottom Extrusion	1.00		-2.3750	LI	W		MF	Y		M-130

TEST SPECIMEN COMPLIES
WITH THESE DETAILS.

ANY DEVIATION IS NOTED.

Bill of Materials Listing

Print Date: Aug 16, 2007

TEST COMPLETE: 9/18/07

NCTL-110-10901

Product: 5010

Type: SH

Assembly Code	Part #	Description	Qty	Height	Width	Unit Code	Vert Hor	Sub Assy	Add Color	Fixed Length	W/Nailing Fin
WTSTPH	W432519W	Weather Strip(H)	1.00			LI		MF			

End of Subassembly MF *****											
CKEYS	V6-211	Corner Keys	4.00			EA		SC			
HEADER	V11BLWT3B	Frame Top Extrusion	1.00		4.3750	LI	W	SC		N	
LATCH	V80082	Swivel Latch	2.00			EA		SC			
LJAMB	V11BLWT3B	Left Side Extrusion	1.00	2.5625		LI	H	SC		N	
POPRVT	V6307W	Pop Rivet	2.00			EA		SC			
RJAMB	V11BLWT3B	Right Side Extrusion	1.00	2.5625		LI	H	SC		N	
SCDEDH	1	Half Screen Deduct		2.5625	4.5000			SC			
SCLOTH	1816	Screen Cloth(Std)	1.00	2.8750	4.4375	SF		SC			
SILL	V11BLWT3B	Bottom Extrusion	1.00		4.3750	LI	W	SC		N	
SSPLIN	.140	Screen Spline	2.00		4.5000	LI	W	SC			

End of Subassembly SC *****

TEST SPECIMEN COMPLIES
WITH THESE DETAILS.
ANY DEVIATION IS NOTED.
TEST COMPLETE: 9/18/07
NCTL 110-10901

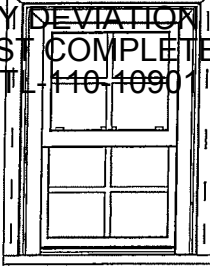

**Series 5010 SH
Vinyl Single Hung Windows**

- Bottom Sash Tilts In And Can Be Removed
- Sloped Sill
- Custom Sizes Available
- 4-9/16" Jamb Extensions: Add \$64.00
- 6-9/16" Jamb Extensions: Add \$87.00

Tempered Glass In Stock:

- 2-8 x 5-0 add \$153.00
- 2-8 x 6-0 add \$184.00
- 3-0 x 5-0 add \$172.00
- 3-0 x 6-0 add \$207.00

Single Units

Stock Size	1/1	GBC	Lite	Low-E	Screen
2-0 x 3-0	138.24	147.92	4/4	17.52	2.63
2-0 x 3-8	146.27	156.51	4/4	21.41	2.81
2-0 x 4-0	150.38	160.91	4/4	23.36	2.91
2-0 x 4-4	154.54	165.36	4/4	25.31	3.00
2-0 x 5-0	162.56	173.94	4/4	29.20	3.19
2-0 x 6-0	175.36	187.64	6/6	35.04	3.46
2-4 x 3-0	143.80	153.87	6/6	20.44	2.81
2-4 x 3-8	150.09	160.60	6/6	24.98	3.00
2-4 x 4-0	156.20	167.13	6/6	27.25	3.10
2-4 x 4-4	160.53	171.77	6/6	29.52	3.19
2-4 x 5-0	168.70	180.51	6/6	34.07	3.39
2-4 x 6-0	181.65	194.37	9/9	40.88	3.67
2-6 x 3-0	150.06	160.56	6/6	21.90	2.89
2-6 x 3-8	158.61	169.71	6/6	26.77	3.09
2-6 x 4-0	162.79	174.19	6/6	29.20	3.19
2-6 x 4-4	167.21	178.91	6/6	31.63	3.28
2-6 x 5-0	175.64	187.93	6/6	36.50	3.49
2-6 x 6-0	185.51	198.50	9/9	43.80	3.78
2-8 x 3-0	156.32	167.26	6/6	23.36	2.98
2-8 x 3-8	165.09	176.65	6/6	28.55	3.19
2-8 x 4-0	169.37	181.23	6/6	31.15	3.29
2-8 x 4-4	173.89	186.06	6/6	33.74	3.37
2-8 x 5-0	182.57	195.35	6/6	38.93	3.60
2-8 x 6-0	191.14	204.52	9/9	46.72	3.91
3-0 x 3-0	162.92	174.32	6/6	26.28	3.15
3-0 x 3-8	172.31	184.37	6/6	32.12	3.36
3-0 x 4-0	176.64	189.00	6/6	35.04	3.46
3-0 x 4-4	181.43	194.13	6/6	37.96	3.58
3-0 x 5-0	190.46	203.79	6/6	43.80	3.79
3-0 x 6-0	198.79	212.71	9/9	52.56	4.11
3-4 x 3-0	169.56	181.43	8/8	29.20	3.32
3-4 x 3-8	179.31	191.86	8/8	35.69	3.55
3-4 x 4-0	184.05	196.93	8/8	38.93	3.67
3-4 x 4-4	190.34	203.66	8/8	42.18	3.77
3-4 x 5-0	199.37	213.33	8/8	48.67	3.99
3-4 x 6-0	207.49	222.01	12/12	58.40	4.34
3-8 x 3-0	176.36	188.71	8/8	32.12	3.48
3-8 x 3-8	186.36	199.41	8/8	39.26	3.74
3-8 x 4-0	191.37	204.77	8/8	42.83	3.86
3-8 x 4-4	196.52	210.28	8/8	46.40	3.98
3-8 x 5-0	206.57	221.03	8/8	53.53	4.20
3-8 x 6-0	216.12	231.25	12/12	64.24	4.56
Custom Size	Next Larger Size + 38.50			+2.92 per sqft	+8.00

Screens Are Net When Purchased By Themselves

MGM Industries
287 Freehill Road
Hendersonville, TN 37075
Office 1-800-476-5584
Fax 1-615-822-6581

TEST SPECIMEN COMPLIES WITH THESE DETAILS

ANY DEVIATION IS NOTED.

TEST COMPLETE: 9/18/07

NCTL-110-10901

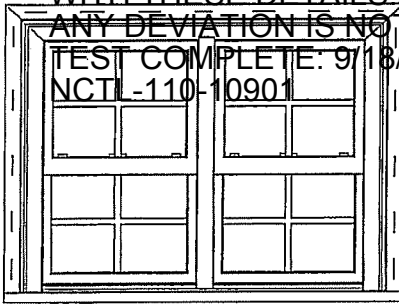

**Series 5010 TWIN
Vinyl Single Hung Windows**

- Bottom Sash Tilts In And Can Be Removed
- Custom Sizes Available
- 4-9/16" Jamb Extensions: Add \$128.00
- 6-9/16" Jamb Extensions: Add \$174.00

Tempered Glass In Stock:

- 2-8 x 5-0 add \$306.00
- 2-8 x 6-0 add \$368.00
- 3-0 x 5-0 add \$344.00
- 3-0 x 6-0 add \$414.00

Twin Units

Stock Size	1/1	GBC	Lite	Low E	Screen
2-0 x 3-0	295.19	314.54	4/4	35.04	5.26
2-0 x 3-8	311.25	331.73	4/4	42.83	5.62
2-0 x 4-0	319.47	340.52	4/4	46.72	5.82
2-0 x 4-4	327.79	349.43	4/4	50.61	6.00
2-0 x 5-0	343.83	366.59	4/4	58.40	6.38
2-0 x 6-0	369.43	393.98	6/6	70.08	6.92
2-4 x 3-0	306.31	326.44	6/6	40.88	5.62
2-4 x 3-8	318.89	339.90	6/6	49.96	6.00
2-4 x 4-0	331.11	352.98	6/6	54.51	6.20
2-4 x 4-4	339.77	362.24	6/6	59.05	6.38
2-4 x 5-0	356.11	379.73	6/6	68.13	6.78
2-4 x 6-0	382.01	407.44	9/9	81.76	7.34
2-6 x 3-0	318.83	339.84	6/6	43.80	5.78
2-6 x 3-8	335.93	358.14	6/6	53.53	6.18
2-6 x 4-0	344.29	367.08	6/6	58.40	6.38
2-6 x 4-4	353.13	376.54	6/6	63.27	6.56
2-6 x 5-0	369.99	394.58	6/6	73.00	6.98
2-6 x 6-0	389.73	415.70	9/9	87.60	7.56
2-8 x 3-0	331.35	353.23	6/6	46.72	5.96
2-8 x 3-8	348.89	372.00	6/6	57.10	6.38
2-8 x 4-0	357.45	381.16	6/6	62.29	6.58
2-8 x 4-4	366.49	390.83	6/6	67.48	6.74
2-8 x 5-0	383.85	409.41	6/6	77.87	7.20
2-8 x 6-0	400.99	427.75	9/9	93.44	7.82
3-0 x 3-0	344.55	367.36	6/6	52.56	6.30
3-0 x 3-8	363.33	387.45	6/6	64.24	6.72
3-0 x 4-0	371.99	396.72	6/6	70.08	6.92
3-0 x 4-4	381.57	406.97	6/6	75.92	7.16
3-0 x 5-0	399.63	426.29	6/6	87.60	7.58
3-0 x 6-0	416.29	444.12	9/9	105.12	8.22
3-4 x 3-0	357.83	381.57	8/8	58.40	6.64
3-4 x 3-8	377.33	402.43	8/8	71.38	7.10
3-4 x 4-0	386.81	412.58	8/8	77.87	7.34
3-4 x 4-4	399.39	426.04	8/8	84.36	7.54
3-4 x 5-0	417.45	445.36	8/8	97.33	7.98
3-4 x 6-0	433.69	462.74	12/12	116.80	8.68
3-8 x 3-0	371.43	396.12	8/8	64.24	6.96
3-8 x 3-8	391.43	417.52	8/8	78.52	7.48
3-8 x 4-0	401.45	428.24	8/8	85.65	7.72
3-8 x 4-4	411.75	439.26	8/8	92.79	7.96
3-8 x 5-0	431.85	460.77	8/8	107.07	8.40
3-8 x 6-0	450.95	481.21	12/12	128.48	9.12
Custom Size	Next Larger Size + 77.00			+5.84	+16.00
				per sqft	

Screens Are Net When Purchased By Themselves

MGM Industries
287 Freehill Road
Hendersonville, TN 37075
Office 1-800-476-5584
Fax 1-615-822-6581

TEST SPECIMEN COMPLIES
WITH THESE DETAILS.
ANY DEVIATION IS NOTED
TEST COMPLETE: 9/18/07
NCT 110-10901

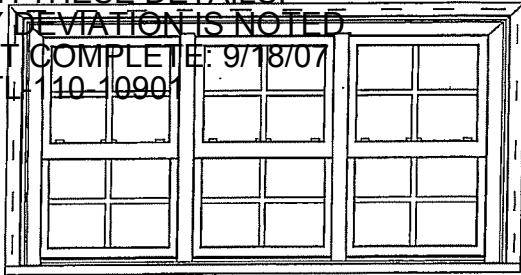

**Series 5010 TRIP
Vinyl Single Hung Windows**

- Bottom Sash Tilts In And Can Be Removed
- Custom Sizes Available
- Continuous Head and Sill
- 4-9/16" Jamb Extensions: Add \$192.00
- 6-9/16" Jamb Extensions: Add \$261.00

Tempered Glass In Stock:

- 2-8 x 5-0 add \$459.00
- 2-8 x 6-0 add \$552.00
- 3-0 x 5-0 add \$516.00
- 3-0 x 6-0 add \$621.00

Triple Units

Stock Size	I/I	GBC	Lite	Low-E	Screen
2-0 x 3-0	452.14	481.17	4/4	52.56	7.89
2-0 x 3-8	476.23	506.95	4/4	64.24	8.43
2-0 x 4-0	488.56	520.14	4/4	70.08	8.73
2-0 x 4-4	501.04	533.49	4/4	75.92	9.00
2-0 x 5-0	525.10	559.24	4/4	87.60	9.57
2-0 x 6-0	563.50	600.33	6/6	105.12	10.38
2-4 x 3-0	468.82	499.02	6/6	61.32	8.43
2-4 x 3-8	487.69	519.21	6/6	74.95	9.00
2-4 x 4-0	506.02	538.82	6/6	81.76	9.30
2-4 x 4-4	519.01	552.72	6/6	88.57	9.57
2-4 x 5-0	543.52	578.95	6/6	102.20	10.17
2-4 x 6-0	582.37	620.52	9/9	122.64	11.01
2-6 x 3-0	487.60	519.11	6/6	65.70	8.67
2-6 x 3-8	513.25	546.56	6/6	80.30	9.27
2-6 x 4-0	525.79	559.98	6/6	87.60	9.57
2-6 x 4-4	539.05	574.16	6/6	94.90	9.84
2-6 x 5-0	564.34	601.22	6/6	109.50	10.47
2-6 x 6-0	593.95	632.91	9/9	131.40	11.34
2-8 x 3-0	506.38	539.21	6/6	70.08	8.94
2-8 x 3-8	532.69	567.36	6/6	85.65	9.57
2-8 x 4-0	545.53	581.10	6/6	93.44	9.87
2-8 x 4-4	559.09	595.61	6/6	101.23	10.11
2-8 x 5-0	585.13	623.47	6/6	116.80	10.80
2-8 x 6-0	610.84	650.98	9/9	140.16	11.73
3-0 x 3-0	526.18	560.39	6/6	78.84	9.45
3-0 x 3-8	554.35	590.54	6/6	96.36	10.08
3-0 x 4-0	567.34	604.43	6/6	105.12	10.38
3-0 x 4-4	581.71	619.81	6/6	113.88	10.74
3-0 x 5-0	608.80	648.80	6/6	131.40	11.37
3-0 x 6-0	633.79	675.54	9/9	157.68	12.33
Custom Size	Next Larger Size +115.50			+8.76	+24.00
				per sqft	

Screens Are Net When Purchased By Themselves

MGM Industries
287 Freehill Road
Hendersonville, TN 37075
Office 1-800-476-5584
Fax 1-615-822-6581

TEST SPECIMEN COMPLIES WITH THESE DETAILS.

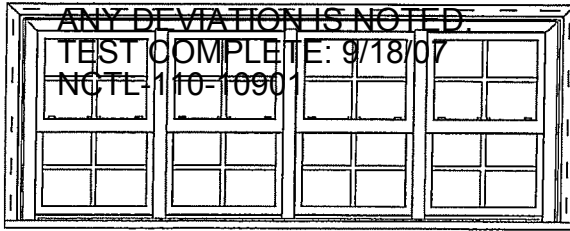

**Series 5010 QUAD
Vinyl Single Hung Windows**

- Bottom Sash Tilts In And Can Be Removed
- Custom Sizes Available
- Continuous Head And Sill On Units Up To 2-8 In Width
- 4-9/16" Jamb Extensions: Add \$256.00
- 6-9/16" Jamb Extensions: Add \$348.00

Tempered Glass In Stock:

- 2-8 x 5-0 add \$612.00
- 2-8 x 6-0 add \$736.00
- 3-0 x 5-0 add \$688.00
- 3-0 x 6-0 add \$828.00

Quad Units

Stock Size	I/I	GBC	Lite	Low E	Screen
2-0 x 3-0	609.09	647.80	4/4	70.08	10.52
2-0 x 3-8	641.21	682.17	4/4	85.65	11.24
2-0 x 4-0	657.65	699.76	4/4	93.44	11.64
2-0 x 4-4	674.29	717.56	4/4	101.23	12.00
2-0 x 5-0	706.37	751.89	4/4	116.80	12.76
2-0 x 6-0	757.57	806.67	6/6	140.16	13.84
2-4 x 3-0	631.33	671.59	6/6	81.76	11.24
2-4 x 3-8	656.49	698.52	6/6	99.93	12.00
2-4 x 4-0	680.93	724.67	6/6	109.01	12.40
2-4 x 4-4	698.25	743.20	6/6	118.10	12.76
2-4 x 5-0	730.93	778.17	6/6	136.27	13.56
2-4 x 6-0	782.73	833.59	9/9	163.52	14.68
2-6 x 3-0	656.37	698.39	6/6	87.60	11.56
2-6 x 3-8	690.57	734.98	6/6	107.07	12.36
2-6 x 4-0	707.29	752.87	6/6	116.80	12.76
2-6 x 4-4	724.97	771.79	6/6	126.53	13.12
2-6 x 5-0	758.69	807.87	6/6	146.00	13.96
2-6 x 6-0	798.17	850.11	9/9	175.20	15.12
2-8 x 3-0	681.41	725.18	6/6	93.44	11.92
2-8 x 3-8	716.49	762.72	6/6	114.20	12.76
2-8 x 4-0	733.61	781.03	6/6	124.59	13.16
2-8 x 4-4	751.69	800.38	6/6	134.97	13.48
2-8 x 5-0	786.41	837.53	6/6	155.73	14.40
2-8 x 6-0	820.69	874.21	9/9	186.88	15.64
Widths Over 2-8 are Shipped as 2 Factory Mull ↓ Twins With a Precut Field H-Mull ↓					
3-0 x 3-0	707.81	753.43	6/6	105.12	12.60
3-0 x 3-8	745.37	793.62	6/6	128.48	13.44
3-0 x 4-0	762.69	812.15	6/6	140.16	13.84
3-0 x 4-4	781.85	832.65	6/6	151.84	14.32
3-0 x 5-0	817.97	871.30	6/6	175.20	15.16
3-0 x 6-0	851.29	906.95	9/9	210.24	16.44
3-4 x 3-0	734.37	781.85	8/8	116.80	13.28
3-4 x 3-8	773.37	823.58	8/8	142.76	14.20
3-4 x 4-0	792.33	843.86	8/8	155.73	14.68
3-4 x 4-4	817.49	870.79	8/8	168.71	15.08
3-4 x 5-0	853.61	909.43	8/8	194.67	15.96
3-4 x 6-0	886.09	944.19	12/12	233.60	17.36
3-8 x 3-0	761.57	810.95	8/8	128.48	13.92
3-8 x 3-8	801.57	853.75	8/8	157.03	14.96
3-8 x 4-0	821.61	875.19	8/8	171.31	15.44
3-8 x 4-4	842.21	897.24	8/8	185.58	15.92
3-8 x 5-0	882.41	940.25	8/8	214.13	16.80
3-8 x 6-0	920.61	981.12	12/12	256.96	18.24
Custom Size	Next Larger Size + 154.00			+11.68	+32.00
				per sqft	

Screens Are Net When Purchased By Themselves

MGM Industries
287 Freehill Road
Hendersonville, TN 37075
Office 1-800-476-5584
Fax 1-615-822-6581

TEST SPECIMEN COMPLIES
 WITH THESE DETAILS.
 ANY DEVIATION IS NOTED.
 TEST COMPLETE: 9/18/07
 NCTL-110-1090

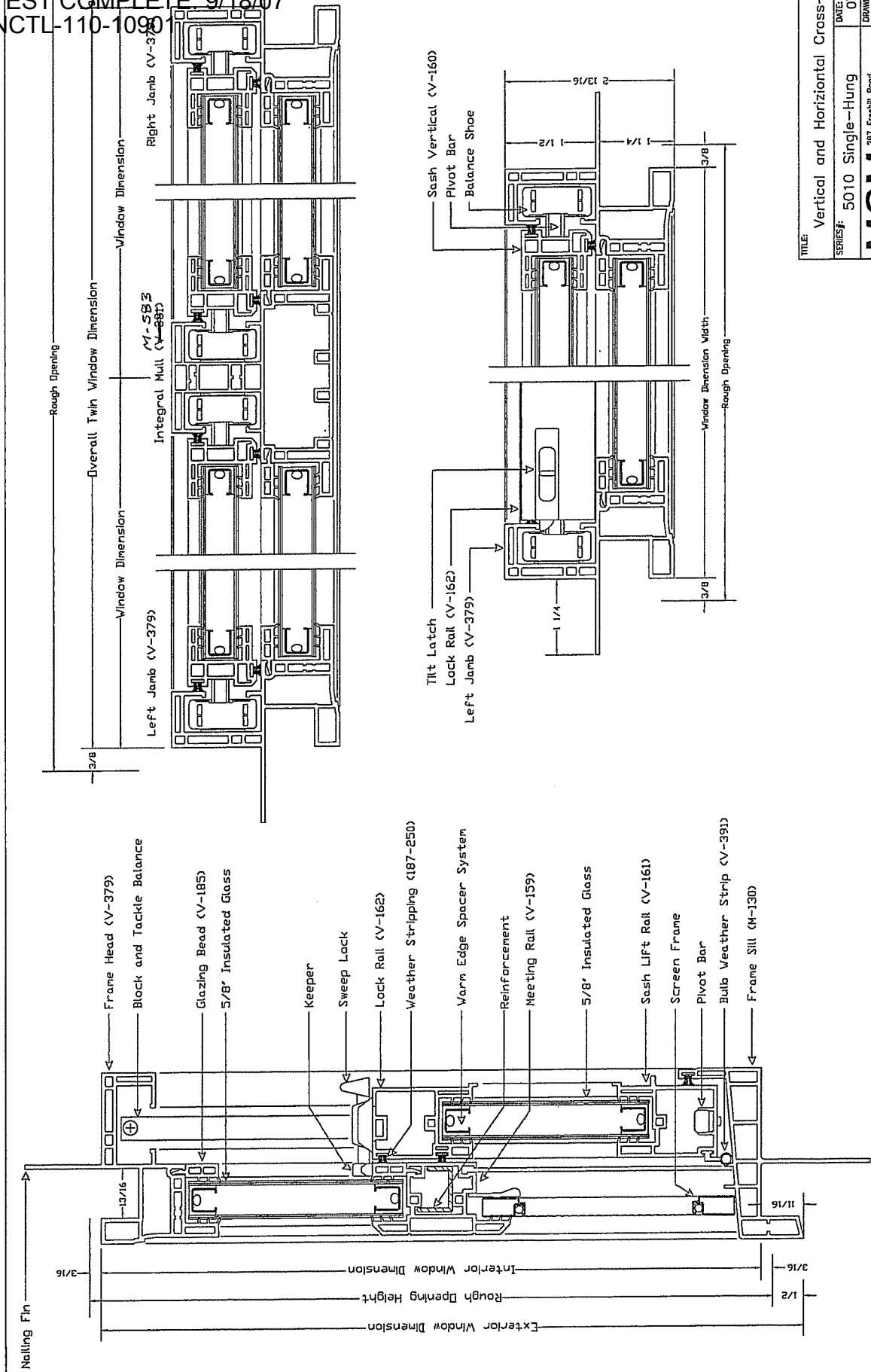

TITLE: Vertical and Horizontal Cross-Section	
SERIES#: 5010 Single-Hung	DATE: 07/01/06
287 Freshhill Road Merrimack, N.H. 03075 Phone: (603) 882-5574 Fax: (603) 882-5581	
DRAWN BY: RGraves	SCALE: Do Not Scale
MGM INDUSTRIES	

TEST SPECIMEN COMPLIES
 WITH THESE DETAILS.
 ANY DEVIATION IS NOTED.
 TEST COMPLETE: 9/18/07
 NCTL-110-10901

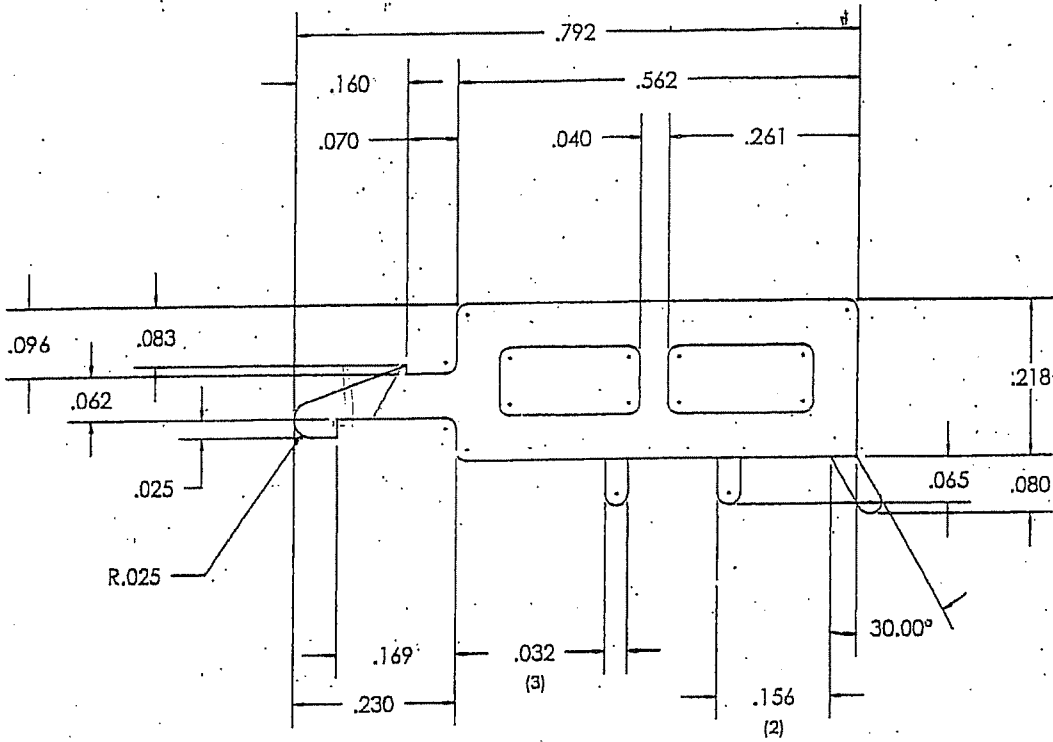

FULL SIZE



NOTE: AREA WT/FT
 RIGID .098 .061
 FLEX .007 .004

MGM Industries INC.

287 Freehill Road
 HENDERSONVILLE, TN 37075

DESCRIPTION: GLAZING BEAD

ALL RADIUS TO BE .015, ALL WALL THK TO BE .062 UNLESS OTHERWISE SPECIFIED

BY MJP
 DATE 10-6-89

P			
O			
L	REDRAWN ON NEW BORDER	MU	6-15-98
REV	DESCRIPTION	BY	DATE

AREA .106 WT/FT .066
 SCALE 4X DIE # V-185

THIS DOCUMENT CONTAINS CONFIDENTIAL AND PROPRIETARY INFORMATION
 DO NOT COPY OR DISCLOSE WITHOUT CONSENT OF VINYLSOURCE INC.

TEST SPECIMEN COMPLIES
 WITH THESE DETAILS.
 ANY DEVIATION IS NOTED.
 TEST COMPLETE: 9/18/07
 NCTL-110-10901

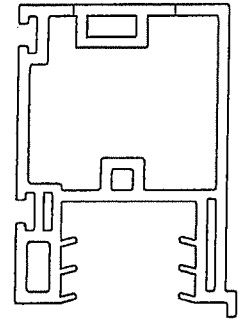

Actual Size

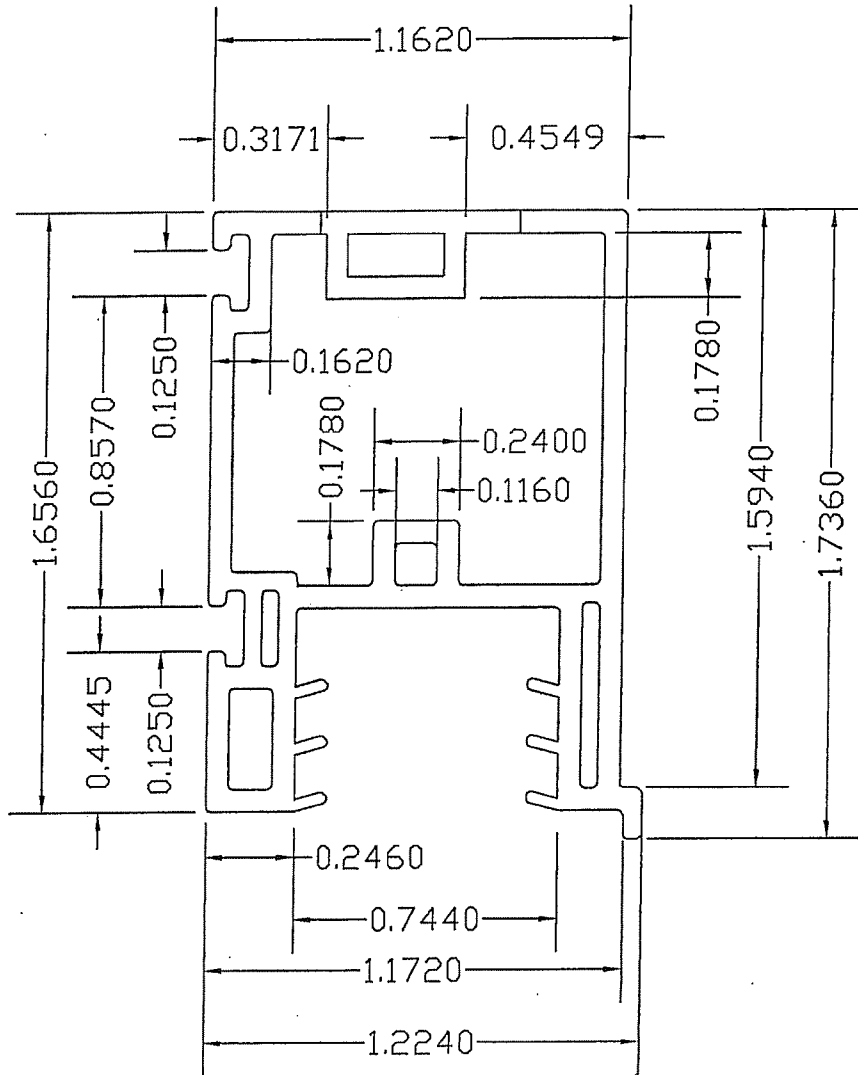

MGM INDUSTRIES
 287 FREEHILL RD
 HENDERSONVILLE, TN
 37075

DESCRIPTION:
 Series #5000
 Lock Rail

ALL RADI TO BE 0.015.
 ALL WALL THK TO BE
 0.0625 UNLESS
 OTHERWISE SPECIFIED.
 INTERNAL WALLS 0.052

DWG. NO.
 V-162

REV.

AREA WT/FT BY: R.Graves

Do not scale drawing

DATE: 11/14/00

TEST SPECIMEN COMPLIES WITH THESE DETAILS.

REVISIONS

ANY DEVIATION IS NOTED.

REV.	DESCRIPTION	DATE	APPROVED
1	add leg		

TEST COMPLETE: 9/18/07
NCTL-110-10901

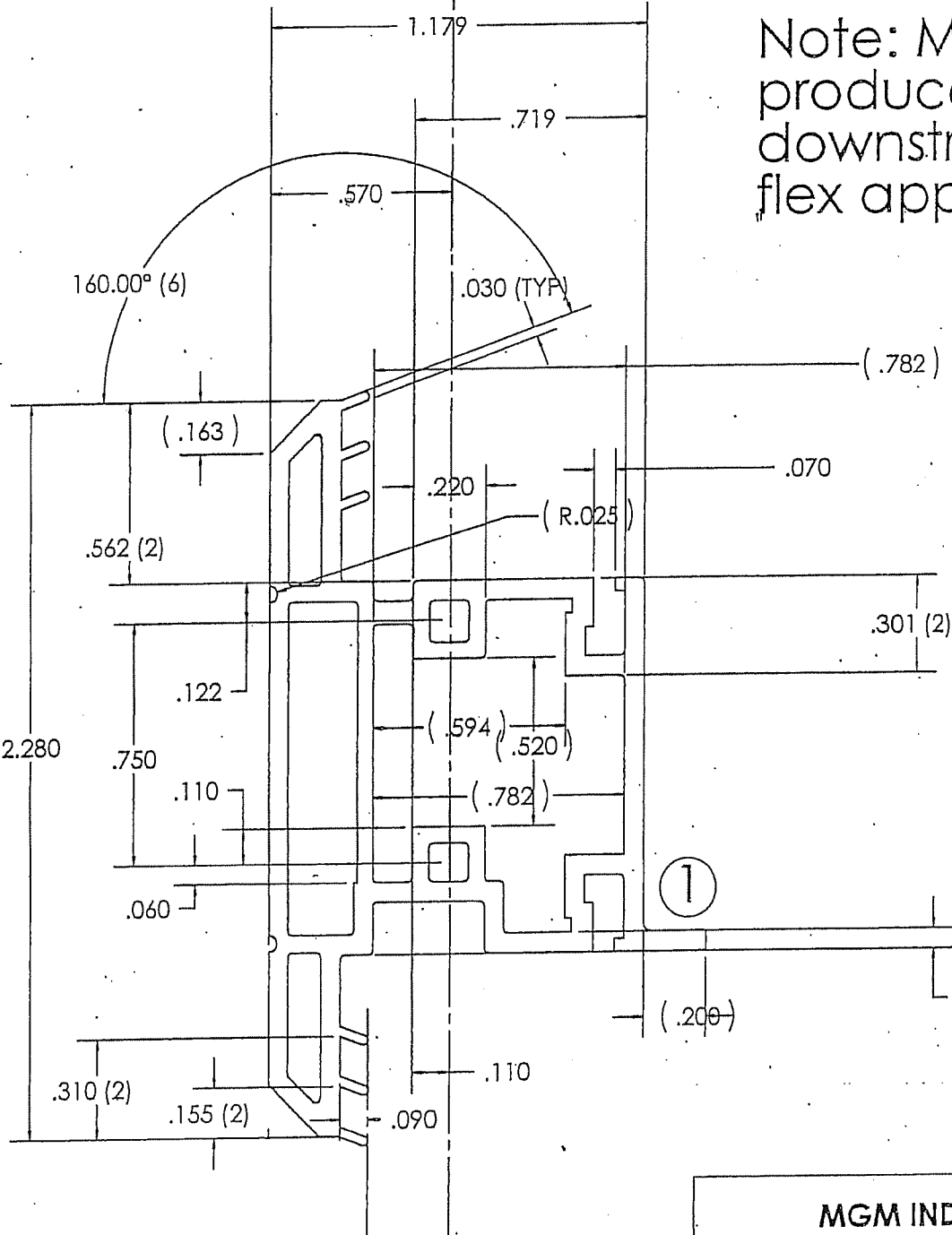

interior walls 0.05 inch

MGM INDUSTRIES

DESCRIPTION:

Keeper rail for 5000 SH

ALL RADIUS TO BE 0.015. ALL WALL THK TO BE 0.0625 UNLESS OTHERWISE SPECIFIED

BY
ABG

DATE
04/25/01

AREA
.594

WT/FT
.371

DIE
M-159

REV	DESCRIPTION	BY	DATE
B			
A			

TEST SPECIMEN COMPLIES WITH THESE DETAILS.

ANY DEVIATION IS NOTED.

TEST COMPLETE: 9/18/07
NCTL-110-10901

REVISIONS

REV.	DESCRIPTION	DATE	APPROVED

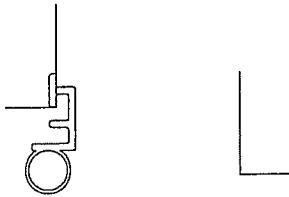
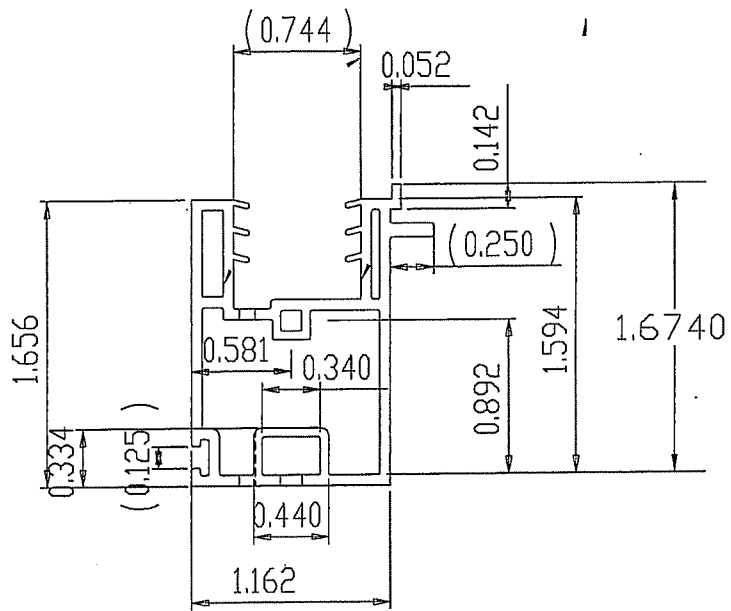

MGM INDUSTRIES 287 FREEHILL ROAD HENDERSONVILLE, TN 37075	DESCRIPTION: 5000 Series Bottom Sash Bottom Rail	ALL RADI TO BE 0.015 ALL WALL THK TO BE 0.062 UNLESS OTHERWISE SPECIFIED INTERNAL WALLS 0.050	DWG. NO. M-161	REV.
	DATE 05/25/01	WEIGHT 0.3385	AREA .525	BY: ABG
DO NOT SCALE DRAWING				

TEST SPECIMEN COMPLIES WITH THESE DETAILS. ANY DEVIATION IS NOTED. TEST COMPLETE: 9/18/07 NCTL-110-10901

REVISIONS

REV.	DESCRIPTION	DATE

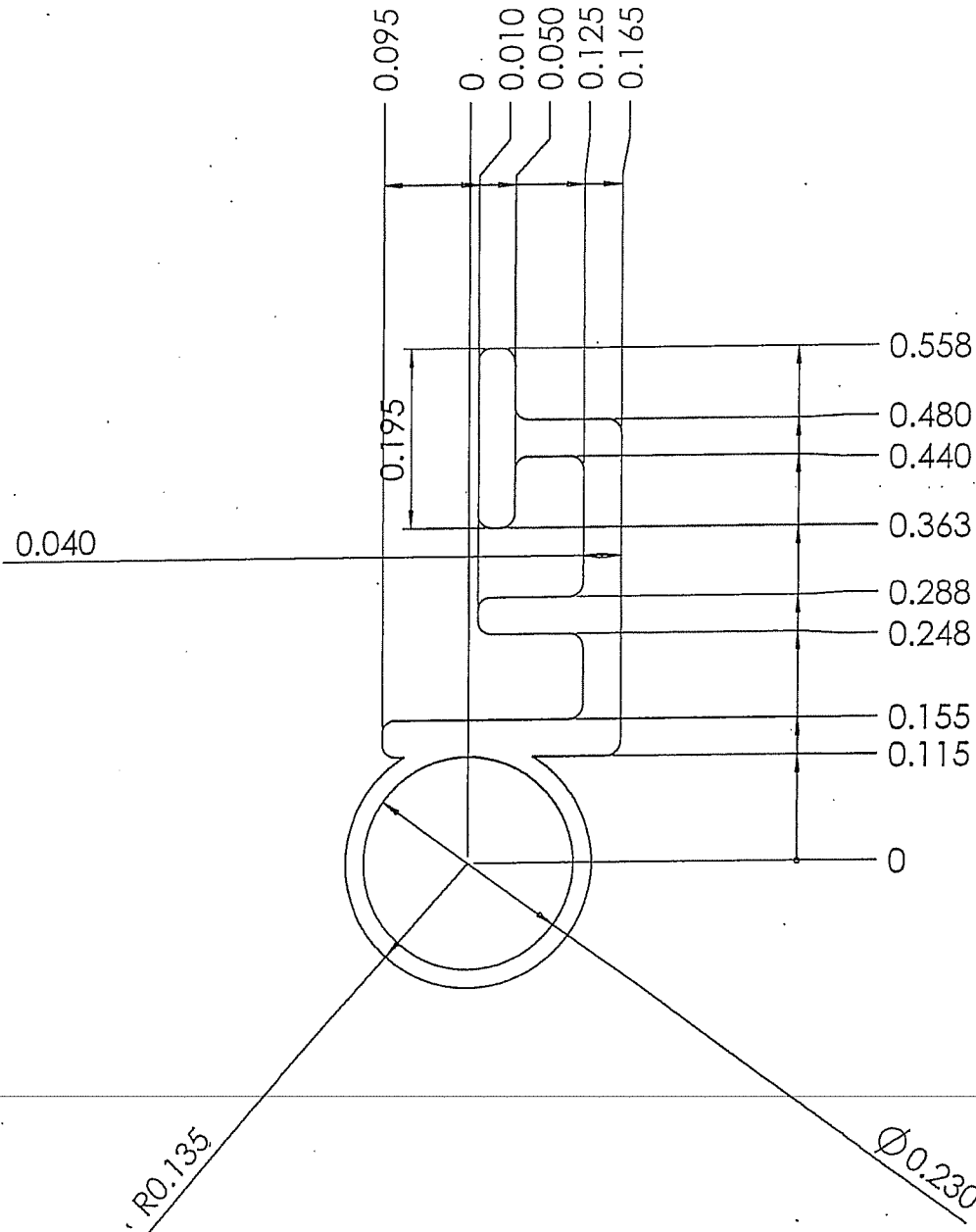

MGM INDUSTRIES
 287 FREEHILL ROAD
 HENDERSONVILLE, TN
 37075
 ph 615-824-6572
 fax 615-822-6581

DESCRIPTION:
 Bulb Seal

ALL RADII TO BE 0.015
 ALL WALL THK TO BE
 0.040 UNLESS
 OTHERWISE SPECIFIED
 INTERNAL WALLS 0.050

DWG. NO.
 V-391

REV.

WEIGHT

AREA

BY: ABG

DATE 12/06/02

DO NOT SCALE DRAWING

TEST SPECIMEN COMPLIES WITH THESE DETAILS.

ANY DEVIATION IS NOTED.
 TEST COMPLETE: 9/18/07
 NCTL-110-10901

REVISIONS

REV.	DESCRIPTION	DATE	APPROVED

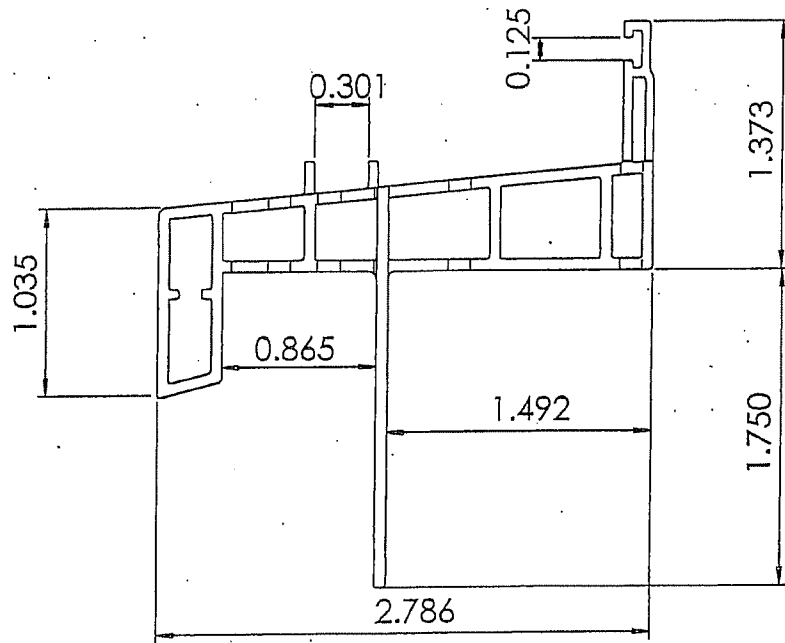

MGM INDUSTRIES
 287 FREEHILL ROAD
 HENDERSONVILLE, TN
 37075

DESCRIPTION:
5000 mainframe Sill

ALL RADI TO BE 0.015
 ALL WALL THK TO BE 0.062 UNLESS OTHERWISE SPECIFIED
 INTERNAL WALLS 0.050

DWG. NO.
M-130

REV:
 PREL

WEIGHT
 .525

AREA
 .841

BY: ABG

DATE 11/29/01

DO NOT SCALE DRAWING

TEST SPECIMEN COMPLIES WITH THESE DETAILS. ANY DEVIATION IS NOTED.		REVISIONS		
REV.	DESCRIPTION	DATE	APPROVED	

TEST COMPLETE: 9/18/07
NCTL-110-10901

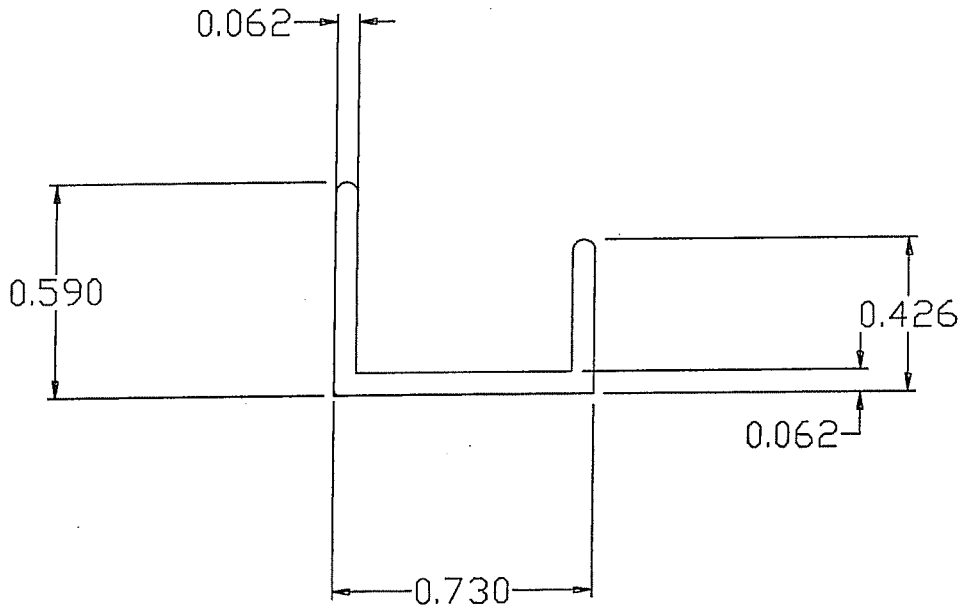

Material: Aluminum (6063)

MGM INDUSTRIES 287 FREEHILL ROAD MENDERSONVILLE, TN 37075	DESCRIPTION: 5000 meeting rail reinforcements	ALL RADI TO BE 0.015 ALL WALL THK TO BE 0.062 UNLESS OTHERWISE SPECIFIED INTERNAL WALLS 0.050	DWG. NO. A-154	REV.
	DATE 10/02/01	WEIGHT 0.120	AREA 0.100	BY: ABG
DO NOT SCALE DRAWING				

TEST SPECIMEN COMPLIES WITH THESE DETAILS ON NEXT ASSY. ANY DEVIATION IS NOTED. TEST COMPLETE: 9/18/07 NCTL-110-10901	REVISIONS			
	REV.	DESCRIPTION	DATE	APPROVED
	1	Dimension was 0.476	01/17/02	

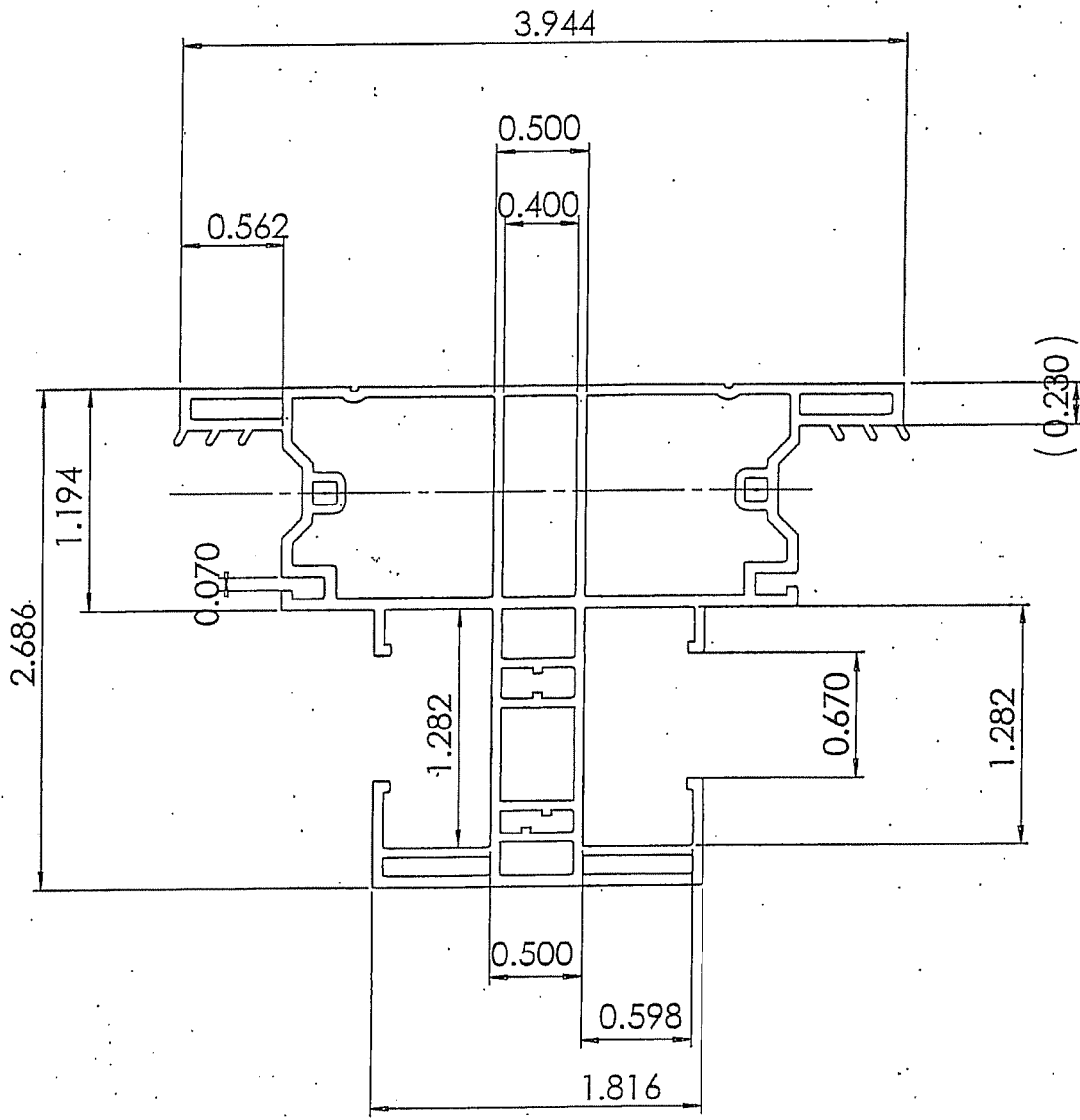

MGM INDUSTRIES 287 FREEHILL ROAD HENDERSONVILLE, TN 37075	DESCRIPTION: 5000 Mutiple Mullion	ALL RADI TO BE 0.015 ALL WALL THK TO BE 0.060 UNLESS OTHERWISE SPECIFIED INTERNAL WALLS 0.050	DWG. NO. M-583	REV. 1
	DATE 01/17/02	WEIGHT 0.7614	AREA 1.2202	BY: ABG
DO NOT SCALE DRAWING				

TEST SPECIMEN COMPLIES
 WITH THESE DETAILS.
 ANY DEVIATION IS NOTED.
 TEST COMPLETE: 9/18/07
 NCTL-110-10901

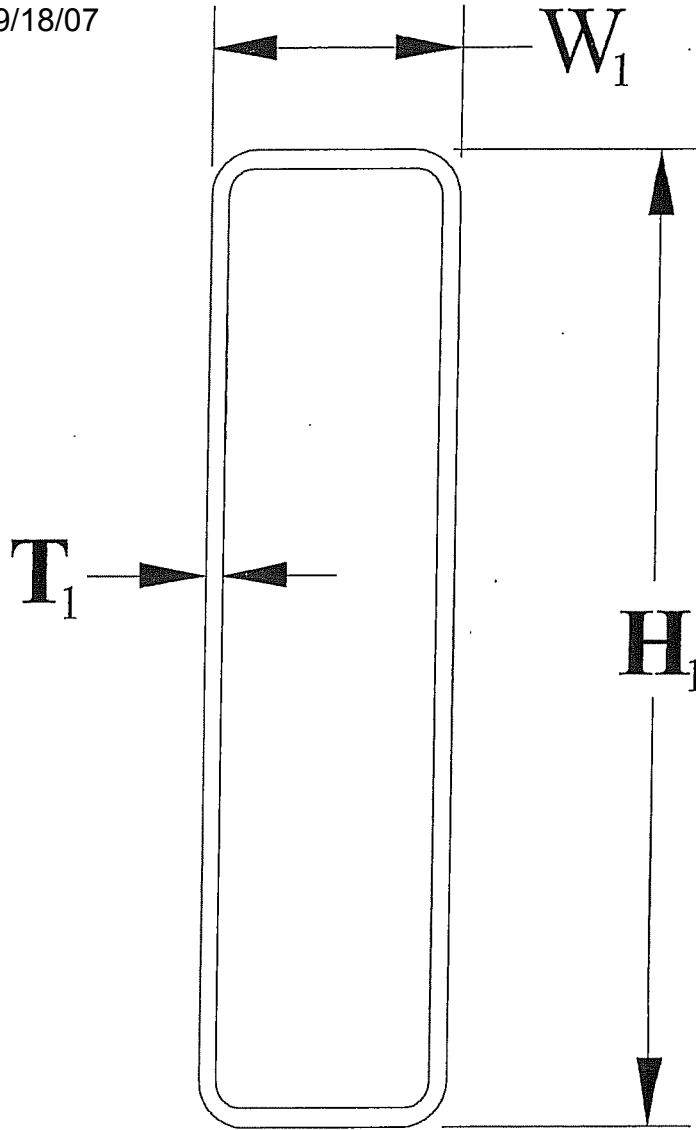

Rectangular

Divider Dimensions - Fill dimensions where applicable - Please fill out a divider sheet for each divider size used.

Dimensions			Material		
<input type="checkbox"/> W_1 <u>.190</u> "	<input type="checkbox"/> W_2 _____ "	<input type="checkbox"/> W_3 _____ "	<input checked="" type="checkbox"/> Aluminum	<input type="checkbox"/> Steel - Galvanized	<input type="checkbox"/> Other _____
<input type="checkbox"/> H_1 <u>.805</u> "	<input type="checkbox"/> H_2 _____ "	<input type="checkbox"/> T_1 <u>.08</u> "	<input type="checkbox"/> Steel - Mild	<input type="checkbox"/> Steel - Stainless	

TEST SPECIMEN COMPLIES WITH THESE DETAILS. ANY DEVIATION IS NOTED. TEST COMPLETE: 9/18/07 NCTL-110-10901

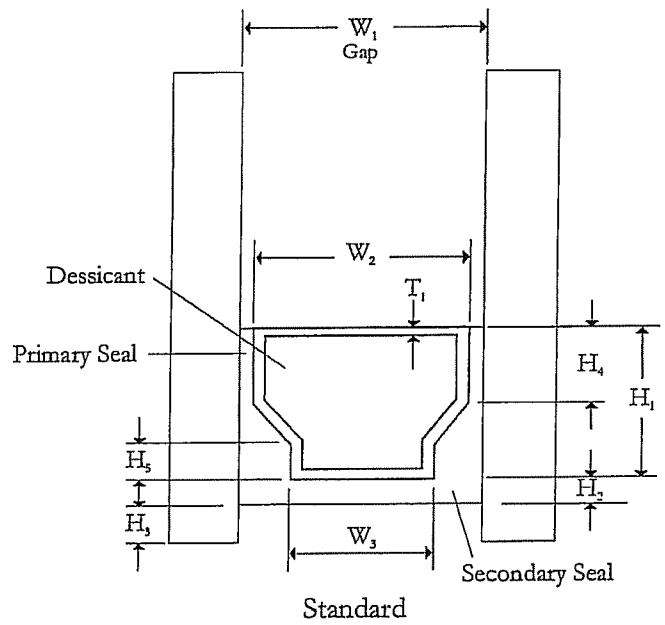
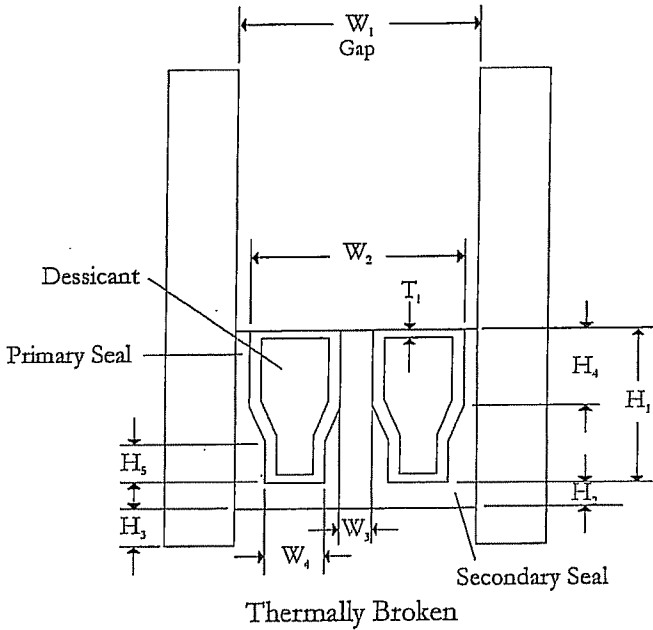
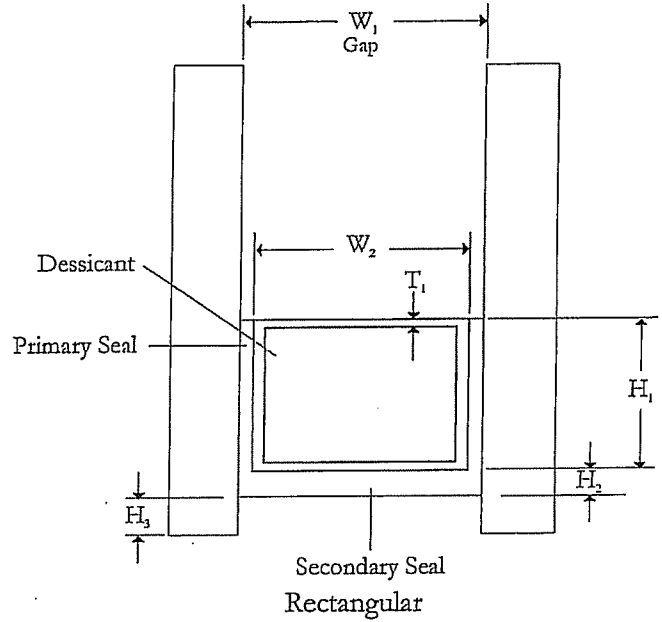
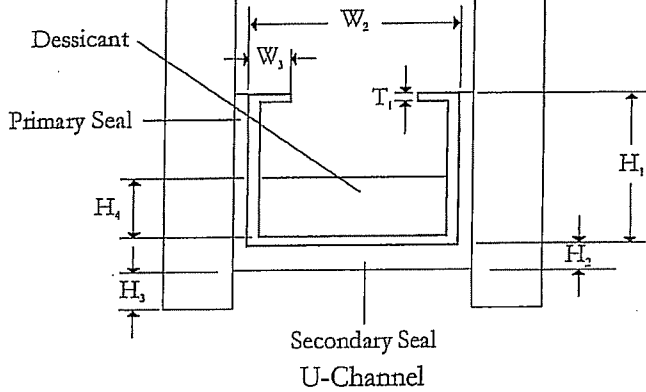

Spacer Dimensions - Fill dimensions where applicable - Please fill out a spacer sheet for each spacer used whether spacer type or size.

Gap	Primary Seal	Secondary Seal	Material	Fill
<input type="checkbox"/> W ₁ .461 "	<input checked="" type="checkbox"/> Butyl	<input checked="" type="checkbox"/> Butyl	<input type="checkbox"/> Aluminum	<input checked="" type="checkbox"/> Dessicant
<input type="checkbox"/> W ₂ .405 "	<input type="checkbox"/> PIB	<input type="checkbox"/> PIB	<input type="checkbox"/> Steel - Mild	<input type="checkbox"/> Air
<input type="checkbox"/> W ₃ .070 "	<input type="checkbox"/> Polysulphide	<input type="checkbox"/> Polysulphide	<input type="checkbox"/> Steel - Stainless	<input type="checkbox"/> Other _____
<input type="checkbox"/> W ₄ _____ "	<input type="checkbox"/> Silicone	<input type="checkbox"/> Silicone	<input checked="" type="checkbox"/> Steel - Galvanized	
<input type="checkbox"/> H ₁ .300 "	<input type="checkbox"/> Urethane	<input type="checkbox"/> Urethane	<input type="checkbox"/> Vinyl	
<input type="checkbox"/> H ₂ .045 "	<input type="checkbox"/> None	<input type="checkbox"/> None	<input type="checkbox"/> Foam _____	
<input type="checkbox"/> H ₃ .08 "	<input type="checkbox"/> Other _____	<input type="checkbox"/> Other _____	<input type="checkbox"/> Other _____	
<input type="checkbox"/> H ₄ .084 "				
<input type="checkbox"/> H ₅ _____ "				
<input type="checkbox"/> T ₁ .013 "				