

# Series 6050 Vinyl Single Hung Windows

Visit [MGMIndustries.com](http://MGMIndustries.com) for a complete online catalog

## Page

- 1 Singles
- 2 Twins
- 3 Triples
- 4 Quads
- 5 Fixed Pictures
- 6 Transoms
- 7 Flankers
- 8 Rough Opening Chart 1
- 9 Rough Opening Chart 2
- 10 Single Hung Window Egress Chart

## Series 6050 Product Information

<u><b>Test</b></u>	<u><b>Result</b></u>
- Air Infiltration	0.12 cfm/sq.ft.
- Water Resistance at 5 gph/sq.ft.	No Leakage
- Max. Water Pressure Achieved	7.5 PSF (Grade 50)
- Design Pressure	50 PSF
- Max. Structural Pressure Achieved	75 PSF
- Overall Rating	H-R50 - 38" x 71"
- R Value Standard Clear Glass	2.04*
- U Value Standard Clear Glass	0.49*
- R Value Low-E Glass	2.86*
- U Value Low-E Glass	0.35*

\* Complete operating unit tested

### **Minimum and Maximum Build Size**

		<b>Single Hung Window Width</b>						
		<b>1-6</b>	<b>2-0</b>	<b>2-4</b>	<b>3-0</b>	<b>3-4</b>	<b>3-8</b>	<b>4-0</b>
<b>H E I G H T</b>	<b>2-9</b>	yes	yes	yes	yes	yes	yes	yes
	<b>4-0</b>	yes	yes	yes	yes	yes	yes	yes
	<b>5-0</b>	yes	yes	yes	yes	yes	yes	yes
	<b>6-0</b>	yes	yes	yes	yes	yes	yes	yes
	<b>*7-0</b>	yes	yes	yes	yes	no	no	no

		<b>Fixed Picture Window Width</b>					
		<b>1-0</b>	<b>2-0</b>	<b>3-0</b>	<b>4-0</b>	<b>5-0</b>	<b>6-0</b>
<b>H E I G H T</b>	<b>1-0</b>	yes	yes	yes	yes	yes	yes
	<b>5-0</b>	yes	yes	yes	yes	yes	yes
	<b>6-0</b>	yes	yes	yes	yes	yes	yes
	<b>*7-0</b>	yes	yes	yes	yes	yes	no
	<b>*8-0</b>	yes	yes	yes	yes	no	no

Any unit over 84" in height or width / over 30 sqft must be tempered

## Series 6050 Window Options

### Standard Features

- Designed for New Home Construction
- Vinyl Brick Mould with Integral "J" Channel
- Integral Nailing Fin
- 3/4" Insulated Glass
- Sloped Sill for Better Water Run-Off
- 1-3/4" Vinyl Jamb
- 13/16" Flat Grilles
- Custom Sizes Available
- Available in White and Tan
- AAMA 101 H-R50 Rating

### Options

- Tan Color: Add 10% to List Price
- Obscure Glass: Add \$3.00/sqft of Window Area
- Bronze/Gray Tint Glass: Add \$3.00/sqft of Window Area
- Aluminum Frame, Fiberglass Mesh Half Screen
- Tempered Glass: Add \$14.04/sqft of Window Area
- Lineal "H" Mull: \$.21 per inch
- 4-9/16" Jamb Extensions Factory Applied: \$64.00
- 4-9/16" Jamb for Specialty Windows: See Specials Pages
- 6-9/16" Jamb Extensions Factory Applied: \$87.00
- Vertical Mull: Add \$18.71
- Tempered Obscure Glass: Add \$19.75/sqft of Window Area
- Tempered Low-E Glass: Add \$20.70/sqft of Window Area
- Niagra Obscure Glass: Add \$3.30/sqft
- Tempered Niagra Obscure Glass: Add \$21.73/sqft of Window Area
- **Custom grilles (Decralite 1-piece grille): 40% upcharge**
- **Prairie (Specialty): 40% upcharge**
- **Gothic Grilles: 40% upcharge**



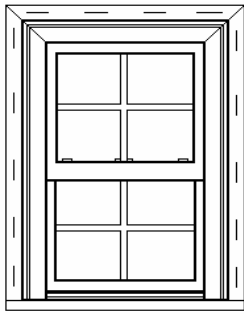

**Series 6050 SH  
Vinyl Single Hung Windows**

**Single Hung 36" x 62" windows meet  
AAMA 101 H-R50 rating**

- Welded Sash and Master Frame
- Operating Sash Tilts In And Can Be Removed
- Interlocking Sash with Intergral Sweeplock
- Custom Sizes Available
- 4-9/16" Jamb Extensions Factory Applied: \$64.00
- 6-9/16" Jamb Extensions Factory Applied: \$87.00

**Single Units**

Stock Size	1/1	GBG	Lite	Low-E	Screen
2-0 x 3-0	138.24	147.92	4/4	18.49	2.63
2-0 x 3-8	146.27	156.51	4/4	22.39	2.81
2-0 x 4-0	150.38	160.91	4/4	24.33	2.91
2-0 x 4-4	154.54	165.36	4/4	26.28	3.00
2-0 x 5-0	162.56	173.94	4/4	30.17	3.19
2-0 x 6-0	175.36	187.64	6/6	36.01	3.46
2-4 x 3-0	143.80	153.87	6/6	21.58	2.81
2-4 x 3-8	150.09	160.60	6/6	26.12	3.00
2-4 x 4-0	156.20	167.13	6/6	28.39	3.10
2-4 x 4-4	160.53	171.77	6/6	30.66	3.19
2-4 x 5-0	168.70	180.51	6/6	35.20	3.39
2-4 x 6-0	181.65	194.37	9/9	42.02	3.67
2-6 x 3-0	150.06	160.56	6/6	23.12	2.89
2-6 x 3-8	158.61	169.71	6/6	27.98	3.09
2-6 x 4-0	162.79	174.19	6/6	30.42	3.19
2-6 x 4-4	167.21	178.91	6/6	32.85	3.28
2-6 x 5-0	175.64	187.93	6/6	37.72	3.49
2-6 x 6-0	185.51	198.50	9/9	45.02	3.78
2-8 x 3-0	156.32	167.26	6/6	24.66	2.98
2-8 x 3-8	165.09	176.65	6/6	29.85	3.19
2-8 x 4-0	169.37	181.23	6/6	32.44	3.29
2-8 x 4-4	173.89	186.06	6/6	35.04	3.37
2-8 x 5-0	182.57	195.35	6/6	40.23	3.60
2-8 x 6-0	191.14	204.52	9/9	48.02	3.91
3-0 x 3-0	162.92	174.32	6/6	27.74	3.15
3-0 x 3-8	172.31	184.37	6/6	33.58	3.36
3-0 x 4-0	176.64	189.00	6/6	36.50	3.46
3-0 x 4-4	181.43	194.13	6/6	39.42	3.58
3-0 x 5-0	190.46	203.79	6/6	45.26	3.79
3-0 x 5-4	195.25	208.92	9/9	46.72	3.91
3-0 x 6-0	198.79	212.71	9/9	54.02	4.11
3-4 x 3-0	169.56	181.43	8/8	30.82	3.32
3-4 x 3-8	179.31	191.86	8/8	37.31	3.55
3-4 x 4-0	184.05	196.93	8/8	40.56	3.67
3-4 x 4-4	190.34	203.66	8/8	43.80	3.77
3-4 x 5-0	199.37	213.33	8/8	50.29	3.99
3-4 x 6-0	207.49	222.01	12/12	60.02	4.34
3-8 x 3-0	176.36	188.71	8/8	33.90	3.48
3-8 x 3-8	186.36	199.41	8/8	41.04	3.74
3-8 x 4-0	191.37	204.77	8/8	44.61	3.86
3-8 x 4-4	196.52	210.28	8/8	48.18	3.98
3-8 x 5-0	206.57	221.03	8/8	55.32	4.20
3-8 x 6-0	216.12	231.25	12/12	66.02	4.56
<b>Custom Size</b>	Next Larger Size + 38.50			+2.92 per sqft	+8.00

**Screens Are Net When Purchased By Themselves**

**MGM Industries**  
287 Freehill Road  
Hendersonville, TN 37075  
Office 1-800-476-5584  
Fax 1-615-822-6581

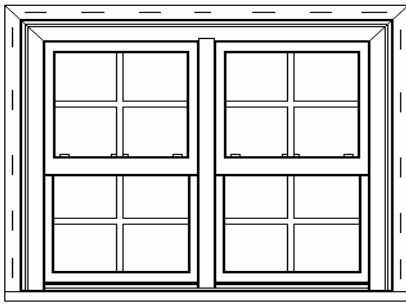

**Series 6050 TWIN**

**Vinyl Single Hung Windows**

**Single Hung 36" x 62" windows meet  
AAMA 101 H-R50 rating**

- Welded Sash and Master Frame
- Operating Sash Tilts In And Can Be Removed
- Interlocking Sash with Intergral Sweeplock
- Custom Sizes Available
- 4-9/16" Jamb Extensions Factory Applied: \$128
- 6-9/16" Jamb Extensions Factory Applied: \$174
- "True" Twin Window, Continuous Head and Sill
- Aluminum Frame, Fiberglass Mesh Half Screen

**Twin Units**

Stock Size	1/1	GBG	Lite	Low-E	Screen
2-0 x 3-0	295.19	314.54	4/4	36.99	5.26
2-0 x 3-8	311.25	331.73	4/4	44.77	5.62
2-0 x 4-0	319.47	340.52	4/4	48.67	5.82
2-0 x 4-4	327.79	349.43	4/4	52.56	6.00
2-0 x 5-0	343.83	366.59	4/4	60.35	6.38
2-0 x 6-0	369.43	393.98	6/6	72.03	6.92
2-4 x 3-0	306.31	326.44	6/6	43.15	5.62
2-4 x 3-8	318.89	339.90	6/6	52.24	6.00
2-4 x 4-0	331.11	352.98	6/6	56.78	6.20
2-4 x 4-4	339.77	362.24	6/6	61.32	6.38
2-4 x 5-0	356.11	379.73	6/6	70.40	6.78
2-4 x 6-0	382.01	407.44	9/9	84.03	7.34
2-6 x 3-0	318.83	339.84	6/6	46.23	5.78
2-6 x 3-8	335.93	358.14	6/6	55.97	6.18
2-6 x 4-0	344.29	367.08	6/6	60.83	6.38
2-6 x 4-4	353.13	376.54	6/6	65.70	6.56
2-6 x 5-0	369.99	394.58	6/6	75.43	6.98
2-6 x 6-0	389.73	415.70	9/9	90.03	7.56
2-8 x 3-0	331.35	353.23	6/6	49.32	5.96
2-8 x 3-8	348.89	372.00	6/6	59.70	6.38
2-8 x 4-0	357.45	381.16	6/6	64.89	6.58
2-8 x 4-4	366.49	390.83	6/6	70.08	6.74
2-8 x 5-0	383.85	409.41	6/6	80.46	7.20
2-8 x 6-0	400.99	427.75	9/9	96.04	7.82
3-0 x 3-0	344.55	367.36	6/6	55.48	6.30
3-0 x 3-8	363.33	387.45	6/6	67.16	6.72
3-0 x 4-0	371.99	396.72	6/6	73.00	6.92
3-0 x 4-4	381.57	406.97	6/6	78.84	7.16
3-0 x 5-0	399.63	426.29	6/6	90.52	7.58
3-0 x 5-4	409.21	436.55	9/9	93.44	7.82
3-0 x 6-0	416.29	444.12	9/9	108.04	8.22
3-4 x 3-0	357.83	381.57	8/8	61.64	6.64
3-4 x 3-8	377.33	402.43	8/8	74.62	7.10
3-4 x 4-0	386.81	412.58	8/8	81.11	7.34
3-4 x 4-4	399.39	426.04	8/8	87.60	7.54
3-4 x 5-0	417.45	445.36	8/8	100.58	7.98
3-4 x 6-0	433.69	462.74	12/12	120.04	8.68
3-8 x 3-0	371.43	396.12	8/8	67.81	6.96
3-8 x 3-8	391.43	417.52	8/8	82.08	7.48
3-8 x 4-0	401.45	428.24	8/8	89.22	7.72
3-8 x 4-4	411.75	439.26	8/8	96.36	7.96
3-8 x 5-0	431.85	460.77	8/8	110.64	8.40
3-8 x 6-0	450.95	481.21	12/12	132.05	9.12
<b>Custom Size</b>	Next Larger Size + 77.00			+5.84 per sqft	+16.00

**Screens Are Net When Purchased By Themselves**

**MGM Industries**

287 Freehill Road  
Hendersonville, TN 37075  
Office 1-800-476-5584  
Fax 1-615-822-6581

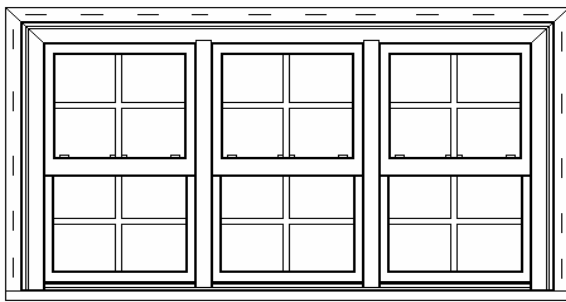

**Series 6050 TRIP**

**Vinyl Single Hung Windows**

**Single Hung 36" x 62" windows meet  
AAMA 101 H-R50 rating**

- Welded Sash and Master Frame
- Operating Sash Tilts In And Can Be Removed
- Interlocking Sash with Intergral Sweeplock
- Custom Sizes Available
- 4-9/16" Jamb Extensions Factory Applied: \$192
- 6-9/16" Jamb Extensions Factory Applied: \$261
- A "True" Triple Window, Continuous Head and Sill
- Aluminum Frame, Fiberglass Mesh Half Screen

**Triple Units**

Stock Size	1/1	GBG	Lite	Low-E	Screen
2-0 x 3-0	452.14	481.17	4/4	55.48	7.89
2-0 x 3-8	476.23	506.95	4/4	67.16	8.43
2-0 x 4-0	488.56	520.14	4/4	73.00	8.73
2-0 x 4-4	501.04	533.49	4/4	78.84	9.00
2-0 x 5-0	525.10	559.24	4/4	90.52	9.57
2-0 x 6-0	563.50	600.33	6/6	108.04	10.38
2-4 x 3-0	468.82	499.02	6/6	64.73	8.43
2-4 x 3-8	487.69	519.21	6/6	78.35	9.00
2-4 x 4-0	506.02	538.82	6/6	85.17	9.30
2-4 x 4-4	519.01	552.72	6/6	91.98	9.57
2-4 x 5-0	543.52	578.95	6/6	105.61	10.17
2-4 x 6-0	582.37	620.52	9/9	126.05	11.01
2-6 x 3-0	487.60	519.11	6/6	69.35	8.67
2-6 x 3-8	513.25	546.56	6/6	83.95	9.27
2-6 x 4-0	525.79	559.98	6/6	91.25	9.57
2-6 x 4-4	539.05	574.16	6/6	98.55	9.84
2-6 x 5-0	564.34	601.22	6/6	113.15	10.47
2-6 x 6-0	593.95	632.91	9/9	135.05	11.34
2-8 x 3-0	506.38	539.21	6/6	73.97	8.94
2-8 x 3-8	532.69	567.36	6/6	89.55	9.57
2-8 x 4-0	545.53	581.10	6/6	97.33	9.87
2-8 x 4-4	559.09	595.61	6/6	105.12	10.11
2-8 x 5-0	585.13	623.47	6/6	120.69	10.80
2-8 x 6-0	610.84	650.98	9/9	144.05	11.73
3-0 x 3-0	526.18	560.39	6/6	83.22	9.45
3-0 x 3-8	554.35	590.54	6/6	100.74	10.08
3-0 x 4-0	567.34	604.43	6/6	109.50	10.38
3-0 x 4-4	581.71	619.81	6/6	118.26	10.74
3-0 x 5-0	608.80	648.80	6/6	135.78	11.37
3-0 x 5-4	623.17	664.17	9/9	140.16	11.73
3-0 x 6-0	633.79	675.54	9/9	162.06	12.33
<b>Custom Size</b>	Next Larger Size + 115.50			+8.76 per sqft	+24.00

**Screens Are Net When Purchased By Themselves  
3-0 x 6-2 is the largest size triple  
available factory mullled**

**MGM Industries**  
287 Freehill Road  
Hendersonville, TN 37075  
Office 1-800-476-5584  
Fax 1-615-822-6581

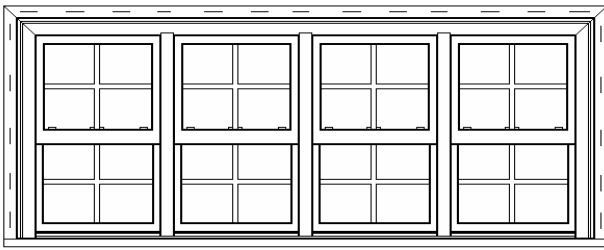

**Series 6050 QUAD  
Vinyl Single Hung Windows**

**Single Hung 36" x 62" windows meet  
AAMA 101 H-R50 rating**

- Welded Sash and Master Frame
- Operating Sash Tilts In And Can Be Removed
- Interlocking Sash with Intergral Sweeplock
- Custom Sizes Available
- 4-9/16" Jamb Extensions Factory Applied: \$256
- 6-9/16" Jamb Extensions Factory Applied: \$348
- A "True" Quad Window, Continuous Head and Sill on 2-0, 2-4, 2-6, 2-8 Widths
- Aluminum Frame, Fiberglass Mesh Half Screen

**Quad Units**

Stock Size	1/1	GBG	Lite	Low-E	Screen
2-0 x 3-0	609.09	647.80	4/4	73.97	10.52
2-0 x 3-8	641.21	682.17	4/4	89.55	11.24
2-0 x 4-0	657.65	699.76	4/4	97.33	11.64
2-0 x 4-4	674.29	717.56	4/4	105.12	12.00
2-0 x 5-0	706.37	751.89	4/4	120.69	12.76
2-0 x 6-0	757.57	806.67	6/6	144.05	13.84
2-4 x 3-0	631.33	671.59	6/6	86.30	11.24
2-4 x 3-8	656.49	698.52	6/6	104.47	12.00
2-4 x 4-0	680.93	724.67	6/6	113.56	12.40
2-4 x 4-4	698.25	743.20	6/6	122.64	12.76
2-4 x 5-0	730.93	778.17	6/6	140.81	13.56
2-4 x 6-0	782.73	833.59	9/9	168.06	14.68
2-6 x 3-0	656.37	698.39	6/6	92.47	11.56
2-6 x 3-8	690.57	734.98	6/6	111.93	12.36
2-6 x 4-0	707.29	752.87	6/6	121.67	12.76
2-6 x 4-4	724.97	771.79	6/6	131.40	13.12
2-6 x 5-0	758.69	807.87	6/6	150.87	13.96
2-6 x 6-0	798.17	850.11	9/9	180.07	15.12
2-8 x 3-0	681.41	725.18	6/6	98.63	11.92
2-8 x 3-8	716.49	762.72	6/6	119.40	12.76
2-8 x 4-0	733.61	781.03	6/6	129.78	13.16
2-8 x 4-4	751.69	800.38	6/6	140.16	13.48
2-8 x 5-0	786.41	837.53	6/6	160.92	14.40
2-8 x 6-0	820.69	874.21	9/9	192.07	15.64
<b>Widths Over 2-8 are Shipped as 2 Factory Mull</b>					
↓ <b>Twins with a Precut Field H-Mull</b> ↓					
3-0 x 3-0	707.81	753.43	6/6	110.96	12.60
3-0 x 3-8	745.37	793.62	6/6	134.32	13.44
3-0 x 4-0	762.69	812.15	6/6	146.00	13.84
3-0 x 4-4	781.85	832.65	6/6	157.68	14.32
3-0 x 5-0	817.97	871.30	6/6	181.04	15.16
3-0 x 5-4	837.13	891.80	9/9	186.88	15.64
3-0 x 6-0	851.29	906.95	9/9	216.08	16.44
3-4 x 3-0	734.37	781.85	8/8	123.29	13.28
3-4 x 3-8	773.37	823.58	8/8	149.24	14.20
3-4 x 4-0	792.33	843.86	8/8	162.22	14.68
3-4 x 4-4	817.49	870.79	8/8	175.20	15.08
3-4 x 5-0	853.61	909.43	8/8	201.16	15.96
3-4 x 6-0	886.09	944.19	12/12	240.09	17.36
3-8 x 3-0	761.57	810.95	8/8	135.62	13.92
3-8 x 3-8	801.57	853.75	8/8	164.17	14.96
3-8 x 4-0	821.61	875.19	8/8	178.44	15.44
3-8 x 4-4	842.21	897.24	8/8	192.72	15.92
3-8 x 5-0	882.41	940.25	8/8	221.27	16.80
3-8 x 6-0	920.61	981.12	12/12	264.10	18.24
<b>Custom Size</b>	Next Larger Size +154.00			+11.68 per sqft	+32.00

**Screens Are Net When Purchased By Themselves**

**MGM Industries**  
287 Freehill Road  
Hendersonville, TN 37075  
Office 1-800-476-5584  
Fax 1-615-822-6581



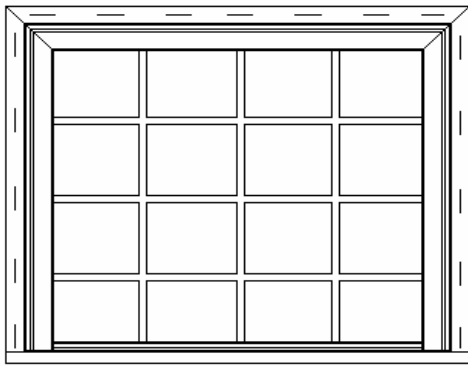

**Series 6050 PICS**

**Sash Set Picture Windows**

- Welded Sash and Master Frame
- Box Sill
- Horizontal Mull: \$58.50
- 4-9/16" Jamb Extensions Factory: \$64.00
- 6-9/16" Jamb Extensions Factory: \$87.00

**Fixed Windows**

Size	1/1	GBG	Lite	Low-E	Tempered
2-0 x 3-2	109.95	118.75	8	18.49	88.92
2-0 x 3-10	119.62	129.19	8	22.39	107.64
2-0 x 4-2	127.67	137.88	8	24.33	117.00
2-0 x 4-6	136.69	147.63	8	26.28	126.36
2-0 x 5-2	142.99	154.43	8	30.17	145.08
2-0 x 6-2	164.93	178.12	12	36.01	173.16
2-8 x 3-2	120.97	130.65	12	24.66	118.56
2-8 x 3-10	130.51	140.95	12	29.85	143.52
2-8 x 4-2	140.18	151.39	12	32.44	156.00
2-8 x 4-6	143.42	154.89	12	35.04	168.48
2-8 x 5-2	162.27	175.25	12	40.23	193.44
2-8 x 6-2	185.69	200.55	18	48.02	230.88
3-0 x 3-2	127.28	137.46	12	27.74	133.38
3-0 x 3-10	135.73	146.59	12	33.58	161.46
3-0 x 4-2	143.52	155.00	12	36.50	175.50
3-0 x 4-6	146.76	158.50	12	39.42	189.54
3-0 x 5-2	167.76	181.18	12	45.26	217.62
3-0 x 6-2	188.77	203.87	18	54.02	259.74
4-0 x 3-2	143.85	155.36	16	36.99	177.84
4-0 x 3-10	162.13	175.10	16	44.77	215.28
4-0 x 4-2	175.79	189.85	16	48.67	234.00
4-0 x 4-6	179.04	193.36	16	52.56	252.72
4-0 x 5-2	184.48	199.24	16	60.35	290.16
4-0 x 6-2	263.32	284.39	24	72.03	346.32
5-0 x 3-2	168.42	181.89	20	46.23	222.30
5-0 x 3-10	176.37	190.48	20	55.97	269.10
5-0 x 4-2	184.78	199.56	20	60.83	292.50
5-0 x 4-6	191.99	207.35	20	65.70	315.90
5-0 x 5-2	272.95	294.79	20	75.43	362.70
5-0 x 6-2	290.84	314.11	30	90.03	432.90
6-0 x 3-2	187.71	202.73	24	55.48	266.76
6-0 x 3-10	232.60	251.21	24	67.16	322.92
6-0 x 4-2	273.28	295.14	24	73.00	351.00
6-0 x 4-6	278.97	301.29	24	78.84	379.08
6-0 x 5-2	285.17	307.98	24	90.52	435.24
<b>*6-0 x 6-2</b>	320.62	346.27	36	108.04	519.48
Custom Size	Next Larger Size + 38.50			2.92/sqft	14.04/sqft
<b>* Windows with over 30 sqft of glass are required to be tempered</b>					

**MGM Industries**

287 Freehill Road  
 Hendersonville, TN 37075  
 Office 1-800-476-5584  
 Fax 1-615-822-6581

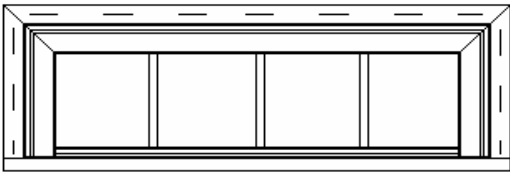

## Series 6050 TR

### 1-Piece Vinyl Fixed Transoms

- **Horizontal Mull: \$58.50**
- Mull "Prep": \$18.71 (Prepared for job-site mulling)
- Tempered Low-E Glass: Add \$20.70/sqft of Window Area

### - 2 and 3 Piece Factory Mulls Units

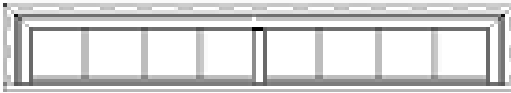

Example: 3/0 Twin x 12" 2-Piece Transom  
 Price: \$114.46 + \$114.46 + \$58.50 + \$18.71  
 [(3/0 x 12") + (3/0 x 12") + Horizontal Mull  
 + Vertical Mull]

**\*\* Please specify 2-piece, 3-piece or continuous when ordering**

- 4-9/16" Jamb Extensions Factory: \$38.50
- 6-9/16" Jamb Extensions Factory: \$52.00

Size	1/1	GBG	Low-E	Tempered
2-0 x 12"	85.90	93.63	5.84	28.08
2-4 x 12"	95.45	104.04	6.81	32.76
2-6 x 12"	100.22	109.24	7.30	35.10
2-8 x 12"	104.99	114.44	7.79	37.44
3-0 x 12"	114.46	124.76	8.76	42.12
3-8 x 12"	126.88	138.30	10.71	51.48
4-0 x 12"	129.61	141.27	11.68	56.16
5-0 x 12"	137.80	150.20	14.60	70.20
6-0 x 12"	146.02	159.16	17.52	84.24
2-0 x 14"	98.79	107.68	6.81	32.76
2-4 x 14"	109.77	119.65	7.95	38.22
2-6 x 14"	115.25	125.62	8.52	40.95
2-8 x 14"	120.74	131.61	9.08	43.68
3-0 x 14"	131.63	143.48	10.22	49.14
3-8 x 14"	145.91	159.04	12.49	60.06
4-0 x 14"	149.05	162.46	13.63	65.52
5-0 x 14"	158.47	172.75	17.03	81.90
6-0 x 14"	167.92	183.03	20.44	98.28
<b>Custom Size</b>	Next Larger Size + 38.50		2.92/sqft	14.04/sqft

**\* Windows with an 96 inch or greater length of glass are required to be tempered**

## MGM Industries

287 Freehill Road  
 Hendersonville, TN 37075  
 Office 1-800-476-5584  
 Fax 1-615-822-6581

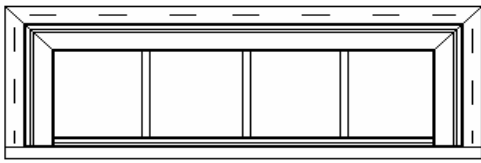

**Series 6050 TR**

**1-Piece Vinyl Fixed Transoms**

- **Horizontal Mull: \$58.50**
- Mull "Prep": \$18.71 (Prepared for job-site mulling)
- Tempered Low-E Glass: Add \$20.70/sqft of Window Area

**- 2 and 3 Piece Factory Mulls Units**

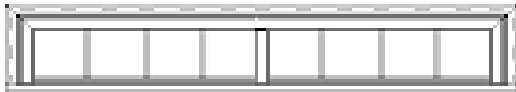

Example: 3/0 Twin x 12" 2-Piece Transom  
 Price: \$114.46+\$114.46+\$58.50+\$18.71  
 [(3/0 x 12") + (3/0 x 12") + Horizontal Mull + Vertical Mull]

**\*\* Please specify 2-piece, 3-piece or continuous when ordering**

- 4-9/16" Jamb Extensions Factory: \$38.50
- 6-9/16" Jamb Extensions Factory: \$52.00

Size	1/1	GBG	Low-E	Tempered
2-0x 18"	118.55	129.22	8.76	42.12
2-4 x 18"	131.72	143.57	10.22	49.14
2-6 x 18"	138.30	150.75	10.95	52.65
2-8 x 18"	144.89	157.93	11.68	56.16
3-0 x 18"	157.96	172.18	13.14	63.18
3-8 x 18"	175.09	190.85	16.06	77.22
4-0 x 18"	178.86	194.96	17.52	84.24
5-0 x 18"	190.18	207.30	21.90	105.30
6-0 x 18"	201.50	219.64	26.28	126.36
2-0x 24"	142.26	155.28	11.68	56.16
2-4 x 24"	158.07	172.30	13.63	65.52
2-6 x 24"	165.96	180.90	14.60	70.20
2-8 x 24"	173.87	189.52	15.57	74.88
3-0 x 24"	189.55	206.61	17.52	84.24
3-8 x 24"	210.11	229.02	21.41	102.96
4-0 x 24"	214.63	233.95	23.36	112.32
5-0 x 24"	228.21	248.75	29.20	140.40
6-0 x 24"	241.80	263.56	35.04	168.48
<b>Custom Size</b>	Next Larger Size + 38.50		2.92/sqft	14.04/sqft

**\* Windows with an 96 inch or greater length of glass are required to be tempered**

**MGM Industries**

287 Freehill Road

Hendersonville, TN 37075

Office 1-800-476-5584

Fax 1-615-822-6581

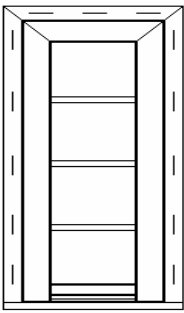

**Series 6050 PIC**

**Vinyl Fixed Flanker Windows**

- Horizontal Mull: \$58.50
- Mull "Prep": \$18.71 (Prepared for job-site mulling)
- Vertical Mull: Add \$18.71
- 4-9/16" Jamb Extensions Factory: \$38.50
- 6-9/16" Jamb Extensions Factory: \$52.00

Stock Sizes	1-Lite	GBG	Lite	Low-E	Tempered
12" x 2-2	99.58	107.55	2	6.33	30.42
12" x 3-2	114.46	123.62	4	9.25	44.46
12" x 3-10	126.88	137.03	4	11.19	53.82
12" x 4-2	129.61	139.98	4	12.17	58.50
12" x 4-6	132.77	143.39	4	13.14	63.18
12" x 5-2	137.81	148.83	4	15.09	72.54
12" x 5-8	142.42	153.81	4	16.55	79.56
12" x 6-2	146.02	157.70	6	18.01	86.58
14" x 2-2	114.52	123.68	2	7.38	35.49
14" x 3-2	131.63	142.16	4	10.79	51.87
14" x 3-10	145.91	157.58	4	13.06	62.79
14" x 4-2	149.05	160.97	4	14.19	68.25
14" x 4-6	152.69	164.91	4	15.33	73.71
14" x 5-2	158.48	171.16	4	17.60	84.63
14" x 5-8	163.78	176.88	4	19.30	92.82
14" x 6-2	167.92	181.35	6	21.01	101.01
<b>Custom Size</b>	Next Larger Size + 38.50			2.92/sqft	14.04/sqft

**MGM Industries**

287 Freehill Road  
 Hendersonville, TN 37075  
 Office 1-800-476-5584  
 Fax 1-615-822-6581

**Series 6050 Vinyl Single Hung Rough Opening Chart**

Size	Single	Factory Mulled		Units Over 2-8's are Job-Site Mull'd
		Twin	Triple	Quad
2-0 x 3-0	24-1/2" x 36-1/2"	49" x 36-1/2"	73-1/2" x 36-1/2"	98" x 36-1/2"
3-8	24-1/2" x 44-1/2"	49" x 44-1/2"	73-1/2" x 44-1/2"	98" x 44-1/2"
4-0	24-1/2" x 48-1/2"	49" x 48-1/2"	73-1/2" x 48-1/2"	98" x 48-1/2"
4-4	24-1/2" x 52-1/2"	49" x 52-1/2"	73-1/2" x 52-1/2"	98" x 52-1/2"
5-0	24-1/2" x 60-1/2"	49" x 60-1/2"	73-1/2" x 60-1/2"	98" x 60-1/2"
6-0	24-1/2" x 72-1/2"	49" x 72-1/2"	73-1/2" x 72-1/2"	98" x 72-1/2"
2-4 x 3-0	28-1/2" x 36-1/2"	57" x 36-1/2"	85-1/2" x 36-1/2"	114" x 36-1/2"
3-8	28-1/2" x 44-1/2"	57" x 44-1/2"	85-1/2" x 44-1/2"	114" x 44-1/2"
4-0	28-1/2" x 48-1/2"	57" x 48-1/2"	85-1/2" x 48-1/2"	114" x 48-1/2"
4-4	28-1/2" x 52-1/2"	57" x 52-1/2"	85-1/2" x 52-1/2"	114" x 52-1/2"
5-0	28-1/2" x 60-1/2"	57" x 60-1/2"	85-1/2" x 60-1/2"	114" x 60-1/2"
6-0	28-1/2" x 72-1/2"	57" x 72-1/2"	85-1/2" x 72-1/2"	114" x 72-1/2"
2-6 x 3-0	30-1/2" x 36-1/2"	61" x 36-1/2"	91-1/2" x 36-1/2"	122" x 36-1/2"
3-8	30-1/2" x 44-1/2"	61" x 44-1/2"	91-1/2" x 44-1/2"	122" x 44-1/2"
4-0	30-1/2" x 48-1/2"	61" x 48-1/2"	91-1/2" x 48-1/2"	122" x 48-1/2"
4-4	30-1/2" x 52-1/2"	61" x 52-1/2"	91-1/2" x 52-1/2"	122" x 52-1/2"
5-0	30-1/2" x 60-1/2"	61" x 60-1/2"	91-1/2" x 60-1/2"	122" x 60-1/2"
6-0	30-1/2" x 72-1/2"	61" x 72-1/2"	91-1/2" x 72-1/2"	122" x 72-1/2"
2-8 x 3-0	32-1/2" x 36-1/2"	65" x 36-1/2"	97-1/2" x 36-1/2"	130" x 36-1/2"
3-8	32-1/2" x 44-1/2"	65" x 44-1/2"	97-1/2" x 44-1/2"	130" x 44-1/2"
4-0	32-1/2" x 48-1/2"	65" x 48-1/2"	97-1/2" x 48-1/2"	130" x 48-1/2"
4-4	32-1/2" x 52-1/2"	65" x 52-1/2"	97-1/2" x 52-1/2"	130" x 52-1/2"
5-0	32-1/2" x 60-1/2"	65" x 60-1/2"	97-1/2" x 60-1/2"	130" x 60-1/2"
6-0	32-1/2" x 72-1/2"	65" x 72-1/2"	97-1/2" x 72-1/2"	130" x 72-1/2"
3-0 x 3-0	36-1/2" x 36-1/2"	73" x 36-1/2"	109-1/2" x 36-1/2"	145-3/4" x 36-1/2"
3-8	36-1/2" x 44-1/2"	73" x 44-1/2"	109-1/2" x 44-1/2"	145-3/4" x 44-1/2"
4-0	36-1/2" x 48-1/2"	73" x 48-1/2"	109-1/2" x 48-1/2"	145-3/4" x 48-1/2"
4-4	36-1/2" x 52-1/2"	73" x 52-1/2"	109-1/2" x 52-1/2"	145-3/4" x 52-1/2"
5-0	36-1/2" x 60-1/2"	73" x 60-1/2"	109-1/2" x 60-1/2"	145-3/4" x 60-1/2"
6-0	36-1/2" x 72-1/2"	73" x 72-1/2"	109-1/2" x 72-1/2"	145-3/4" x 72-1/2"
3-4 x 3-0	40-1/2" x 36-1/2"	81" x 36-1/2"	N/A	161-3/4" x 36-1/2"
3-8	40-1/2" x 44-1/2"	81" x 44-1/2"	N/A	161-3/4" x 44-1/2"
4-0	40-1/2" x 48-1/2"	81" x 48-1/2"	N/A	161-3/4" x 48-1/2"
4-4	40-1/2" x 52-1/2"	81" x 52-1/2"	N/A	161-3/4" x 52-1/2"
5-0	40-1/2" x 60-1/2"	81" x 60-1/2"	N/A	161-3/4" x 60-1/2"
6-0	40-1/2" x 72-1/2"	81" x 72-1/2"	N/A	161-3/4" x 72-1/2"
3-8 x 3-0	44-1/2" x 36-1/2"	89" x 36-1/2"	N/A	177-3/4" x 36-1/2"
3-8	44-1/2" x 44-1/2"	89" x 44-1/2"	N/A	177-3/4" x 44-1/2"
4-0	44-1/2" x 48-1/2"	89" x 48-1/2"	N/A	177-3/4" x 48-1/2"
4-4	44-1/2" x 52-1/2"	89" x 52-1/2"	N/A	177-3/4" x 52-1/2"
5-0	44-1/2" x 60-1/2"	89" x 60-1/2"	N/A	177-3/4" x 60-1/2"
6-0	44-1/2" x 72-1/2"	89" x 72-1/2"	N/A	177-3/4" x 72-1/2"

2-8 and larger Quads are shipped as 2 factory mulled twins with a precut field H-Mull

**Series 6050 Vinyl Transom and Picture Window  
Rough Opening Chart**

<b>Rectangular Transom</b>	
12"	add 12-1/2"
14"	add 14-1/2"

<b>Picture Window</b>	<b>Rough Opening</b>
2-0 x 3-0	24-1/2" x 36-1/2"
2-0 x 3-8	24-1/2" x 44-1/2"
2-0 x 4-0	24-1/2" x 48-1/2"
2-0 x 4-4	24-1/2" x 52-1/2"
2-0 x 5-0	24-1/2" x 60-1/2"
2-0 x 6-0	24-1/2" x 72-1/2"
2-8 x 3-0	32-1/2" x 36-1/2"
2-8 x 3-8	32-1/2" x 44-1/2"
2-8 x 4-0	32-1/2" x 48-1/2"
2-8 x 4-4	32-1/2" x 52-1/2"
2-8 x 5-0	32-1/2" x 60-1/2"
2-8 x 6-0	32-1/2" x 72-1/2"
3-0 x 3-0	36-1/2" x 36-1/2"
3-0 x 3-8	36-1/2" x 44-1/2"
3-0 x 4-0	36-1/2" x 48-1/2"
3-0 x 4-4	36-1/2" x 52-1/2"
3-0 x 5-0	36-1/2" x 60-1/2"
3-0 x 6-0	36-1/2" x 72-1/2"
4-0 x 3-0	48-1/2" x 36-1/2"
4-0 x 3-8	48-1/2" x 44-1/2"
4-0 x 4-0	48-1/2" x 48-1/2"
4-0 x 4-4	48-1/2" x 52-1/2"
4-0 x 5-0	48-1/2" x 60-1/2"
4-0 x 6-0	48-1/2" x 72-1/2"
5-0 x 3-0	60-1/2" x 36-1/2"
5-0 x 3-8	60-1/2" x 44-1/2"
5-0 x 4-0	60-1/2" x 48-1/2"
5-0 x 4-4	60-1/2" x 52-1/2"
5-0 x 5-0	60-1/2" x 60-1/2"
5-0 x 6-0	60-1/2" x 72-1/2"
6-0 x 3-0	72-1/2" x 36-1/2"
6-0 x 3-8	72-1/2" x 44-1/2"
6-0 x 4-0	72-1/2" x 48-1/2"
6-0 x 4-4	72-1/2" x 52-1/2"
6-0 x 5-0	72-1/2" x 60-1/2"
6-0 x 6-0	72-1/2" x 72-1/2"

**MGM Industries**  
 287 Freehill Road  
 Hendersonville, TN 37075  
 Office 1-800-476-5584  
 Fax 1-615-822-6581

**Series 6050 Single Hung  
WIDTH**

**EGRESS SQFT**

		Call-Out	2/0	2/4	2/6	2/8	3/0	3/4	3/6	3/8	4/0
		MS	23.5	27.5	29.5	31.5	35.5	39.5	41.5	43.5	47.5
Call-Out	MS	Opening	19.030	23.030	25.030	27.030	31.030	35.030	37.030	39.030	43.030
3/0	35.50	12.375	1.6	2.0	2.2	2.3	2.7	3.0	3.2	3.4	3.7
3/2	37.50	13.375	1.8	2.1	2.3	2.5	2.9	3.3	3.4	3.6	4.0
3/4	39.50	14.375	1.9	2.3	2.5	2.7	3.1	3.5	3.7	3.9	4.3
3/6	41.50	15.375	2.0	2.5	2.7	2.9	3.3	3.7	4.0	4.2	4.6
3/8	43.50	16.375	2.2	2.6	2.8	3.1	3.5	4.0	4.2	4.4	4.9

<b>H</b>	4/0	47.50	18.375	2.4	2.9	3.2	3.4	4.0	4.5	4.7	5.0	5.5
<b>E</b>	4/2	49.50	19.375	2.6	3.1	3.4	3.6	4.2	4.7	5.0	5.3	5.8
<b>I</b>	4/4	51.50	20.375	2.7	3.3	3.5	3.8	4.4	5.0	5.2	5.5	6.1
<b>G</b>	4/6	53.50	21.375	2.8	3.4	3.7	4.0	4.6	5.2	5.5	5.8	6.4
<b>H</b>	4/8	55.50	22.375	3.0	3.6	3.9	4.2	4.8	5.4	5.8	6.1	6.7

**T**

5/0	59.50	24.375	3.2	3.9	4.2	4.6	5.3	5.9	6.3	6.6	7.3
5/2	61.50	25.375	3.4	4.1	4.4	4.8	5.5	6.2	6.5	6.9	7.6
5/4	63.50	26.375	3.5	4.2	4.6	5.0	5.7	6.4	6.8	7.1	7.9
5/6	65.50	27.375	3.6	4.4	4.8	5.1	5.9	6.7	7.0	7.4	8.2
5/8	67.50	28.375	3.7	4.5	4.9	5.3	6.1	6.9	7.3	7.7	8.5

6/0	71.50	30.375	4.0	4.9	5.3	5.7	6.5	7.4	7.8	8.2	9.1
-----	-------	--------	-----	-----	-----	-----	-----	-----	-----	-----	-----

Egress Min. Opening Width=20"xMin. Opening Height=22".

MS = Make Size

